

A RESOLUTION AUTHORIZING THE MAYOR AND THE FINANCE DIRECTOR TO MAKE APPLICATION FOR A PROGRAM YEAR 29 COMMUNITY DEVELOPMENT BLOCK GRANT AND DECLARING AN EMERGENCY

BE IT RESOLVED by the Council of the Village of Richfield, Summit County, State of Ohio:

SECTION 1. That the Mayor and the Finance Director be, and they hereby are, authorized and directed to make application for a Program Year 29 Community Development Block Grant in accordance with a memorandum from the Summit County Department of Development dated June 10, 2002, a copy of which is attached hereto as Exhibit "A" and incorporated herein fully as if by reference.

SECTION 2. This Resolution is hereby declared to be an emergency measure necessary for the immediate preservation of the public health safety and welfare and for the further reason that it is immediately necessary in order to make timely application for CDBG monies; wherefore, provided this Resolution receives the affirmative vote of two-thirds of the members of Council elected or appointed, it shall take effect immediately upon its passage and execution by the Mayor; otherwise, it shall take effect and be in force from and after the earliest period allowed by law.

PASSED: June 18 2002

May N. Malone
President of Council

Donald W. Jensen
Mayor

Dated: 6/19/2002

ATTEST:

Carole Elson

Clerk of Council

APPLICATION FOR FINANCIAL ASSISTANCE

Revised 4/99

IMPORTANT: Please consult the "Instructions for Completing the Project Application" for assistance in completion of this form.

SUBDIVISION: Village of Richfield CODE # 153 66530

DISTRICT NUMBER: 8 COUNTY: Summit DATE 6/28/02

CONTACT: Melanie A. Tibbs PHONE # (330) 659-9201 ext. 5 (THE PROJECT CONTACT PERSON SHOULD BE THE INDIVIDUAL WHO WILL BE AVAILABLE DURING BUSINESS HOURS AND WHO CAN BEST ANSWER OR COORDINATE THE RESPONSE TO QUESTIONS)

FAX: (330) 659-6935 E-MAIL richvill@voyager.net

PROJECT NAME: The Estates and Heights Water Line Extension Phase I - Engineering

Table with 3 columns: SUBDIVISION TYPE (Check Only 1), FUNDING TYPE REQUESTED (Check All Requested & Enter Amount), PROJECT TYPE (Check Largest Component). Includes options like 1.County, 2.City, 3.Township, 4.Village, 5.Water/Sanitary District, 1.Grant \$50,000.00, 2.Loan \$, 3.Loan Assistance\$, 1.Road, 2.Bridge/Culvert, 3.Water Supply, 4.Wastewater, 5.Solid Waste, 6.Stormwater.

TOTAL PROJECT COST: \$100,000.00 FUNDING REQUESTED: \$50,000.00

DISTRICT RECOMMENDATION To be completed by the District Committee ONLY

GRANT: \$ LOAN ASSISTANCE: \$

SCIP LOAN: \$ RATE: % TERM: yrs.

RLP LOAN: \$ RATE: % TERM: yrs.

(Check Only 1)

State Capital Improvement Program Small Government Program

Local Transportation Improvements Program

FOR OPWC USE ONLY

PROJECT NUMBER: C / C

APPROVED FUNDING: \$

Local Participation %

Loan Interest Rate: %

OPWC Participation %

Loan Term: years

Project Release Date:

Maturity Date:

OPWC Approval:

Date Approved:

SCIP Loan RLP Loan

1.0 PROJECT FINANCIAL INFORMATION

1.1 PROJECT ESTIMATED COSTS: (Round to Nearest Dollar)

Force Account
Dollars

TOTAL DOLLARS

- a.) Basic Engineering Services: \$ 100,000.00
- Preliminary Design \$ 20,000.00
Final Design \$ 80,000.00
Bidding \$ n/a
Construction Phase \$ n/a
- Additional Engineering Services \$ n/a .00
*Identify services and costs below.
- b.) Acquisition Expenses:
Land and/or Right of Way \$ n/a .00
- c.) Construction Costs: \$ n/a .00
- d.) Equipment Purchased Directly: \$ n/a .00
- e.) Permits, Advertising, Legal: \$ n/a .00
(Or Interest Costs for Loan Assistance
Applications Only)
- f.) Construction Contingencies: \$ n/a .00
- g.) TOTAL ESTIMATED COSTS: \$ 100,000.00

*List Additional Engineering Services here:
Service:

Cost:

n/a

n/a

1.2 PROJECT FINANCIAL RESOURCES:
(Round to Nearest Dollar and Percent)

	DOLLARS	%
a.) Local In-Kind Contributions	\$ <u>n/a</u> .00	
b.) Local Revenues	\$ <u>50,000</u> .00	50%
c.) Other Public Revenues		
ODOT	\$ <u>n/a</u> .00	
Rural Development	\$ <u>n/a</u> .00	
OEPA	\$ <u>n/a</u> .00	
OWDA	\$ <u>n/a</u> .00	
CDBG	\$ <u>n/a</u> .00	
OTHER _____	\$ <u>n/a</u> .00	
 SUBTOTAL LOCAL RESOURCES:	 \$ <u>50,000</u> .00	 50%
d.) OPWC Funds		
Grant	\$ _____ 50,000 .00	50%
2. Loan	\$ <u>n/a</u> .00	
3. Loan Assistance	\$ <u>n/a</u> .00	
 SUBTOTAL OPWC FUNDS:	 \$ <u>50,000</u> .00	 50%
e.) TOTAL FINANCIAL RESOURCES:	\$ <u>100,000</u> .00	<u>100%</u>

1.3 AVAILABILITY OF LOCAL FUNDS:

Attach a statement signed by the Chief Financial Officer listed in section 5.2 certifying all local share funds required for the project will be available on or before the earliest date listed in the Project Schedule section.

ODOT PID# _____ Sale Date:
STATUS: (Check one)
 Traditional
 Local Planning Agency (LPA)
 State Infrastructure Bank

2.0 PROJECT INFORMATION

If the project is multi-jurisdictional, information must be consolidated in this section.

2.1 PROJECT NAME: The Estates and Heights Water Line Extension
Phase I - Engineering

2.2 BRIEF PROJECT DESCRIPTION - (Sections A through C):

A: SPECIFIC LOCATION:

See Attached

PROJECT ZIP CODE: 44286

B: PROJECT COMPONENTS:

See Attached

C: PHYSICAL DIMENSIONS:

See Attached

D: DESIGN SERVICE CAPACITY:

Detail current service capacity versus proposed service level.

See Attached

Road or Bridge: Current ADT n/a Year: n/a Projected ADT: n/a Year: n/a

Water/Wastewater: Based on monthly usage of 7,756 gallons per household, attach current rate ordinance. Current Residential Rate: \$ _____ Proposed Rate: \$ City of Cleveland Water

Stormwater: Number of households served: n/a

2.3 USEFUL LIFE/COST ESTIMATE: Project Useful Life: 50 Years.

Attach Registered Professional Engineer's statement, with original seal and signature confirming the project's useful life indicated above and estimated cost.

ISSUE 2/SCIP PROGRAM YEAR 2003

2.2 Brief Project Description

A: Specific Location:

The Estates and Heights Water Line Extension Phase I – Engineering

This project will be located in the Village of Richfield on Amelia Road, Donna Road, Monica Road, Richlawn Drive and Paula Road, Muriel Road, Virginia Road, St. Nicholas Road, Christine Road, Harold Drive, Five Oaks, Motor Road, and Ratener Road. These roads are located in the southwest quadrant of our community and begin on our southern most boundary the Village line of Everett Road. These roads are approximately ¼ of a mile from Brecksville Road. Please see map below.

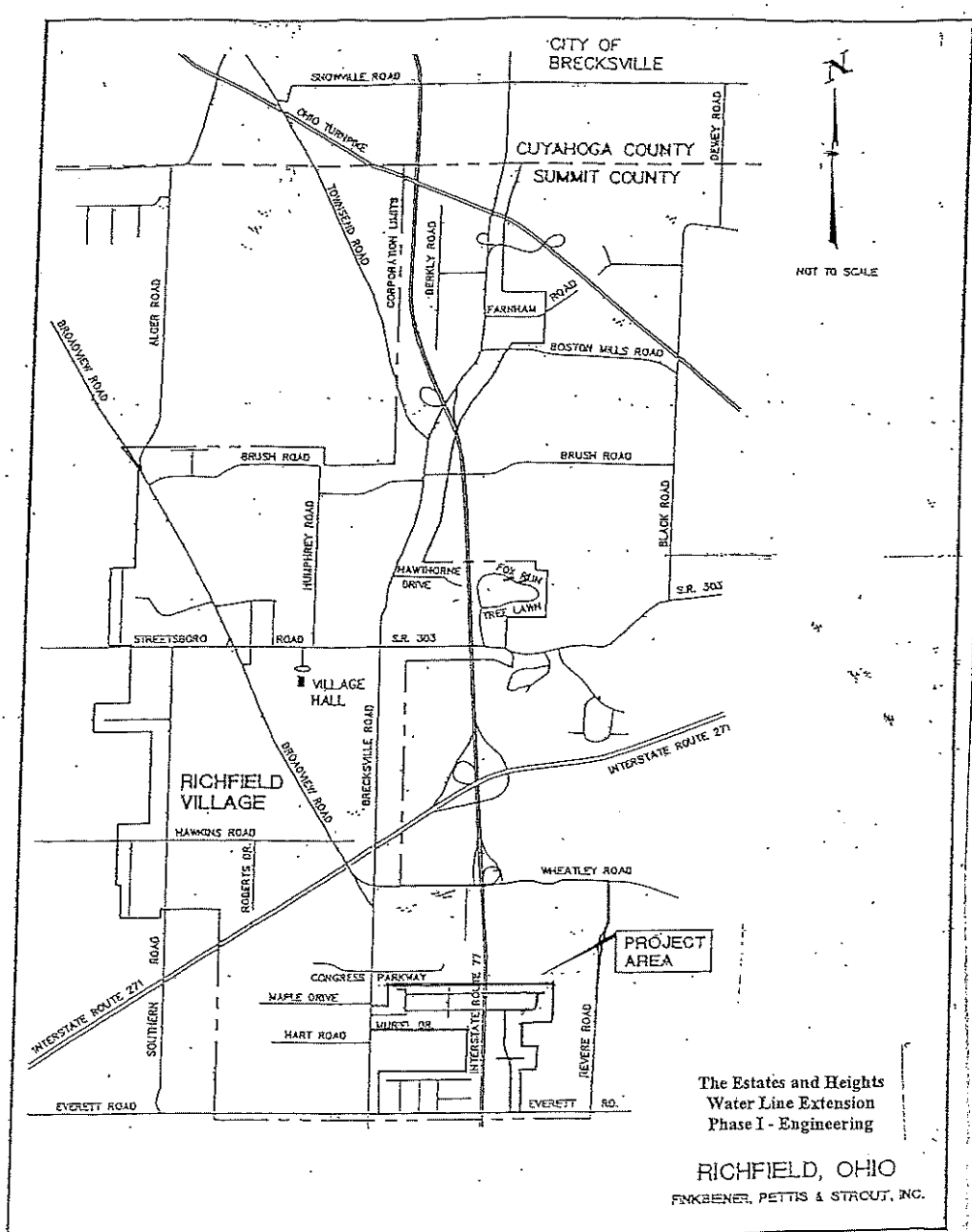

ISSUE 2/SCIP PROGRAM YEAR 2003

2.2 Brief Project Description

B: Project Components:

The Estates and Heights Water Line Extension Phase I – Engineering

This project consists of engineering a new water line extension to the Village residents of Amelia Road, Donna Road, Monica Road, Richlawn Drive and Paula Road, Muriel Road, Virginia Road, St. Nicholas Road, Christine Road, Harold Drive, Five Oaks, Motor Road, and Ratener Road. This line would be designed and engineered as an 8" service line that will connect into the existing 12" water line that is currently located on Brecksville Road and will be looped back out to the new 12" water line being installed on Everett Road this year.

The Village of Richfield has received several petitions for water to service this area. All the residents of this area have wells. Most of the petitioners feel that the water in this area is of poor quality and the quantity over the years appears to be getting lower. (Some have reported that wells have had to be dug deeper.) In addition these roads / developments are surrounded by Interstate I-77 and heavy industrial use properties. It is the contention of the property owners that over time these heavy industrial users have had a detrimental affect on their wells.

This proposed new 8" water line will be about 20,100 lineal feet (3.80 miles) long. As a part of the design there will be new hydrants as required by the City of Cleveland Water specifications. As well, a part of the design will allow the residents to have an opportunity to receive individual hook ups for their house holds. These individual hook ups will be extended to the edge of the road right of way. This will allow for tie-ins to individual homes to be much easier and economical for the homeowners.

This engineering would be the first phase to begin the upgrade to this area. This new line once engineered would hold the potential for 214 parcel owners to hook into city water and abandon their outdated wells.

It is the desire of the Village of Richfield to phase this project. The 1st phase would be to receive money for engineering and have the project engineered. It is the Village's hopes to have the engineering completed within the year 2003. The Village would then attempt for Issue II funding for the extension of this project as a 2nd phase. We are estimating a proposed cost for construction of this project once engineered to be in excess of \$1,900,000.00.

ISSUE 2/SCIP PROGRAM YEAR 2003

2.2 Brief Project Description

C: Physical Dimensions:

The Estates and Heights Water Line Extension Phase I – Engineering

This project consists of engineering a new water line extension to the Village residents of Amelia Road, Donna Road, Monica Road, Richlawn Drive and Paula Road, Muriel Road, Virginia Road, St. Nicholas Road, Christine Road, Harold Drive, Five Oaks, Motor Road, and Ratener Road.

This water line engineering will be designed to run from the existing 12" line located on Brecksville Road and loop back to the new 12" line being installed this year on Everett Road. The proposed new water line will run through these roads / developments approximately 20,100 lineal feet or 3.80 miles.

The proposed new 8" water line will be engineered to run as follows:

<u>Size of line</u>	<u>Length</u>	<u>Street</u>	<u>Side of the road</u>
8"	1,056	Amelia	East
8"	1,056	Donna	West
8"	1,637	Five Oaks	North
8"	4,013	Harold	South
8"	1,109	Monica	East
8"	3,062	Motor	West
8"	1,003	Muriel	South
8"	989	Paula	South
8"	792	Ratener	North
8"	2,429	Richlawn	South
8"	1,954	St. Nicholas	North
8"	1,003	Virginia	East

The engineering design will also consist of fire hydrants as per the City of Cleveland specifications.

There will also be a crossing of Interstate I-77, which will require ODOT specifications and the City of Cleveland specifications.

ISSUE 2/SCIP PROGRAM YEAR 2003

2.2 Brief Project Description

D: Design Service Capacity:

The Estates and Heights Water Line Extension Phase I – Engineering

This project consists of an 8” water line to the Village residents of Amelia Road, Donna Road, Monica Road, Richlawn Drive and Paula Road, Muriel Road, Virginia Road, St. Nicholas Road, Christine Road, Harold Drive, Five Oaks, Motor Road, and Ratener Road.

Current Service Capacity:

This area of Richfield Village does not currently have water service available. The existing homes are on individual water wells. The existing systems are at least 25 years old. Most of the houses were built in the mid-nineteen sixties and are over 35 years old. These parcels / developments are surrounded by Interstate I-77 and heavy industrial uses. It is the contention of the property owners that over time these heavy industrial users have had a detrimental affect on their wells. As well due to the current weather conditions of the past few years some of these residents have had to dig their wells deeper due to the drop in the water table. Finally, this is an area in our community with smaller lots and a higher density. The majority of these homes / parcels are tied into the same water table.

Proposed Service Level:

It is the Village’s desire to engineer this new 8” water line as requested and then attempt Issue II to implement the engineered plans as designed. The Village believes that this project would improve 214 residential lots and improve the lifestyles of all individuals in this area. Once the design is complete and the project can move forward, it would allow for the abandonment of the existing outdated wells and would allow the homeowners a more environmentally safe option for their water needs.

Please see the drawing attached. The highlighted area shows the proposed location for the engineering.

The Estates and Heights Water Line Extension Phase I - Engineering

AREA FROM CITY
OF BRECKENRIDGE



3.0 REPAIR/REPLACEMENT or NEW/EXPANSION:

TOTAL PORTION OF PROJECT REPAIR/REPLACEMENT \$ n/a
TOTAL PORTION OF PROJECT NEW/EXPANSION \$100,000.00

4.0 PROJECT SCHEDULE:*

	BEGIN DATE	END DATE
4.1 Engineering/Design:	<u>3 / 31 / 03</u>	<u>12 / 31 / 03</u>
4.2 Bid Advertisement and Award:	<u>n / a</u>	<u>n / a</u>
4.3 Construction:	<u>n / a</u>	<u>n / a</u>
4.4 Right-of-Way/Land Acquisition	<u>n / a</u>	<u>n / a</u>

* Failure to meet project schedule may result in termination of agreement for approved projects. Modification of dates must be requested in writing by the CEO of record and approved by the commission once the Project Agreement has been executed. The project schedule should be planned around receiving a Project Agreement on or about July 1st.

5.0 PROJECT OFFICIALS:

5.1 CHIEF EXECUTIVE OFFICER Donald H. Larsen
TITLE Mayor
STREET 4410 W. Streetsboro Road

CITY/ZIP Richfield, Ohio 44286
PHONE (330) 659 - 9201 ext. 1
FAX (330) 659 - 4906
E-MAIL

5.2 CHIEF FINANCIAL OFFICER Eleanor Lukovics
TITLE Finance Director
STREET 4410 W. Streetsboro Road

CITY/ZIP Richfield, Ohio 44286
PHONE (330) 659 - 9201 ext. 2
FAX (330) 659 - 0686
E-MAIL

5.3 PROJECT MANAGER Melanie A. Tibbs
TITLE Service Director
STREET 4410 W. Streetsboro Road

CITY/ZIP Richfield, Ohio 44286
PHONE (330) 659 - 9201 ext. 5
FAX (330) 659 - 6935
E-MAIL richvill@voyager.net

Changes in Project Officials must be submitted in writing from the CEO.

6.0 ATTACHMENTS/COMPLETENESS REVIEW:

Confirm in the blocks [] below that each item listed is attached.

- A certified copy of the legislation by the governing body of the applicant authorizing a designated official to sign and submit this application and execute contracts. This individual should sign under 7.0, Applicant Certification, below.
- A certification signed by the applicant's chief financial officer stating all local share funds required for the project will be available on or before the dates listed in the Project Schedule section. If the application involves a request for loan (RLP or SCIP), a certification signed by the CFO which identifies a specific revenue source for repaying the loan also must be attached. Both certifications can be accomplished in the same letter.
- A registered professional engineer's detailed cost estimate and useful life statement, as required in 164-1-13, 164-1-14, and 164-1-16 of the Ohio Administrative Code. Estimates shall contain an engineer's original seal or stamp and signature.
- A cooperation agreement (if the project involves more than one subdivision or district) which identifies the fiscal and administrative responsibilities of each participant.
- Projects which include new and expansion components and potentially affect productive farmland should include a statement evaluating the potential impact. If there is a potential impact, the Governor's Executive Order 98-VII and the OPWC Farmland Preservation Review Advisory apply.
- Capital Improvements Report: (Required by O.R.C. Chapter 164.06 on standard form)
- Supporting Documentation: Materials such as additional project description, photographs, economic impact (temporary and/or full time jobs likely to be created as a result of the project), accident reports, impact on school zones, and other information to assist your district committee in ranking your project. Be sure to include supplements which may be required by your *local* District Public Works Integrating Committee.

7.0 APPLICANT CERTIFICATION:

The undersigned certifies: (1) he/she is legally authorized to request and accept financial assistance from the Ohio Public Works Commission as identified in the attached legislation; (2) to the best of his/her knowledge and belief, all representations that are part of this application are true and correct; (3) all official documents and commitments of the applicant that are part of this application have been duly authorized by the governing body of the applicant; and, (4) should the requested financial assistance be provided, that in the execution of this project, the applicant will comply with all assurances required by Ohio Law, including those involving Buy Ohio and prevailing wages.

Applicant certifies that physical construction on the project as defined in the application has NOT begun, and will not begin until a Project Agreement for this project has been executed with the Ohio Public Works Commission. Action to the contrary will result in termination of the agreement and withdrawal of Ohio Public Works Commission funding from the project.

Certifying Representative (Type or Print Name and Title)

Original Signature/Date Signed

Donald H. Larsen, Mayor