

RESOLUTION NO. 69-1989

Offered by Mr. Morrison and Mayor Waszak

A RESOLUTION AUTHORIZING THE MAYOR AND DIRECTOR OF FINANCE TO ENTER INTO A PROJECT GRANT AGREEMENT WITH THE DIRECTOR OF THE OHIO PUBLIC WORKS COMMISSION FOR THE TRAFFIC SIGNALIZATION INFRASTRUCTURE PROJECT AND DECLARING AN EMERGENCY

BE IT RESOLVED by the Council of the Village of Richfield, State of Ohio:

SECTION 1: That the Mayor and Finance Director be, and they hereby are, authorized and directed to enter into an agreement with the Director of the Ohio Public Works Commission for the traffic signalization infrastructure project, a copy of which agreement is attached hereto as Exhibit "A" and incorporated herein fully as if by reference.

SECTION 2: This Resolution is hereby declared to be an emergency measure necessary for the immediate preservation of the public health, safety and welfare, and for the further reason to allow the commencement of the project as promptly as possible; and provided this Resolution receives the affirmative vote of two-thirds of the members elected or appointed, it shall take effect and be in force from and after its approval by the Mayor; otherwise, it shall take effect and be in force from and after the earliest date provided by law.

Passed: 10/17/89

David W. Howard
President of Council

Ray H. Waszak
Mayor

Dated: 10/17/89

ATTEST:

Mary L. Hegley
Clerk of Council

SUMMIT COUNTY INFRASTRUCTURE COMMITTEE
APPLICATION FOR FUNDING

Date 09 /29 / 89
Funding Year 1990

Check appropriate funding source request:

State Issue 2 _____ Gas Tax X

Project Name: TRAFFIC SIGNAL REPLACEMENT - INTERSECTION S.R. 176/S.R. 303

Applicant: VILLAGE OF RICHFIELD

Type of Applicant: City _____ Village X Township _____

Is the applicant's updated 5 Year capital improvements plan on file?
YES _____ Attached? _____

Is the applicant's 2 year history of capital improvements on file?
YES _____ Attached? _____

Is the applicant's updated inventory of infrastructure on file? YES
Attached? _____

Has the enabling legislation for this project been enacted? _____
Attached? _____ Res. #71-1989 will be adopted 10-3-89 and will follow

Applicant's priority rating # 1 of 1 projects (set
priorities for State Issue 2 projects and Gas Tax projects separately).

Project description: Total replacement of signalization at the intersection
of State Highways 176 and 303 - major crossroads in Richfield Village

What percentage of total project is: Repair _____ Replacement 100%
New _____ Expansion _____ (total of all categories must equal 100%)

Location: S.R. 176 and S.R. 303 intersection - center of Richfield Village

Does this project benefit more than one political subdivision?
Yes X No _____ If yes, describe how Richfield Township, parts of Cuyahoga
County (southwest area) traffic will be served

Age of existing infrastructure to be repaired or replaced at least 40 years

Physical condition of infrastructure to be repaired or replaced:
(describe) _____

Existing signalization is obsolete and sub-standard creating a potential
traffic hazard and requiring extensive continuous repair which is not
economical.

Describe why project is needed Time controlled signals are sub-standard
and need to be replaced with fully actuated signals. Application for funding
was submitted and prioritized too low by AMATS

Estimated useful life of project 40 years

Have there been any agency findings against the existing infrastructure
Yes _____ No X If yes, describe _____

Has the infrastructure been banned from use or expansion of use by a
governmental agency? Yes _____ No v If yes, describe _____

How many persons will benefit from the project? _____ Describe basis
of this estimate: _____

PROJECT STATUS AND SCHEDULE:

	Estimated Start Date	Estimated Completion Date
Preliminary Design	<u>March 1990</u>	<u>May 1990</u>
Detailed Design and Bid Documents Site Related	<u>March 1990</u>	<u>July 1990</u>
Construction Bid Process	<u>August 1990</u>	<u>September 1990</u>
Construction	<u>September 1990</u>	<u>December 1990</u>

ESTIMATED COST:

Preliminary Engineering	\$ <u>6,000</u>	Equipment & Facilities	\$ <u> </u>
Site Related	<u> </u>	Contingencies	<u>5,000</u>
Construction Engineering	<u>5,000</u>	Other (explain)	<u> </u>
Construction	<u>60,000</u>	TOTAL	\$ <u>76,000</u>

PROPOSED FUNDING:

Category	Amount	Percent
Federal/State	\$ <u> </u>	<u> </u>
State only	<u> </u>	<u> </u>
Local	<u> </u>	<u> </u>
Other (explain)	<u> </u>	<u> </u>
OPWC (State Issue 2)	<u> </u>	<u> </u>
Gas Tax	<u> </u>	<u> </u>

Approved: _____

Title: Mayor - Village of Richfield



AMATS

APPLICATION FOR FAUS/FAMA PROJECT FUNDING

Village of Richfield

Project Applicant: _____ Contact Person: Larry Wilson Date: 2-20-89

Name of Highway: S.R. 176 and S.R. 303 Route: _____

Project Limits: _____

Description of Proposed Work: Update intersection by traffic signal replacement

Traffic Signals <u>X</u>	Parking Controls _____	Traffic Channelization _____
Reconstruction _____	Drainage _____	New Road _____
Widening _____	Resurfacing _____	Turn Controls _____
Bridge Replacement _____		

Purpose of Improvement: Eliminate aging time controlled signals that are sub-standard.
Replace with fully actuated signals.

Existing Conditions:

Number of Lanes 2

Turn Lanes None

Lane Widths 12'

Parking Permitted No

Surface Material 404 Asphalt

Shoulder Width 4'

Shoulder Material 304 Limestone

Types of Surface Distress None

Proposed Conditions:

2

None

12'

No

404 Asphalt

4'

304 Limestone

Has your community completed any accident studies or level of service studies for this project? No If yes, please submit a copy.

Will this project:

- eliminate an abrupt change of capacity (bottleneck) along a roadway? Yes
- alleviate highway sections that interrupt the continuous movement of traffic? _____
- serve major activity centers? No Which one(s): _____
- establish a system of interconnected traffic signals to improve flow? NO

Is this project on the locally adopted thoroughfare plan or other master plan? Yes
If yes, please submit a copy.

Is this project a phase of a larger project? No Describe: _____

If sufficient federal funds are not available for the entire project, could a portion of the project be built first and the remainder later? No

Explain: _____

If this project ends at a corporation line, how will this project be coordinated with the adjacent jurisdiction? N/A

Name of Jurisdiction: N/A

Does the adjacent jurisdiction plan on extending the project? N/A

Give the estimated project cost and proposed funding for each phase as shown below.

	FEDERAL FUNDS	ODOT FUNDS	LOCAL FUNDS	TOTAL FUNDS
PRELIM. ENGIN.	<u>N/A</u>	<u> </u>	<u> </u>	<u>N/A</u>
PLAN DEVELOPMENT	<u>N/A</u>	<u> </u>	<u> </u>	<u>N/A</u>
RIGHT OF WAY	<u> </u>	<u> </u>	<u> </u>	<u>N/A</u>
CONSTRUCTION	<u> </u>	<u> </u>	<u> </u>	<u>60,000</u>
CONTINGENCIES	<u> </u>	<u> </u>	<u> </u>	<u>5,000</u>
INSPECTION & CONST. ENGIN.	<u> </u>	<u> </u>	<u> </u>	<u>5,000</u>
TOTAL COST	<u> </u>	<u> </u>	<u> </u>	<u>\$70,000</u>

How will the local share of the project be financed? General Fund

Will assessments be used to pay a portion of the local cost? No

To what extent? _____

Has ODOT agreed to financially participate in this project? Unknown

Provide the project schedule you anticipate:

ACTION	MONTH AND YEAR
PF Form Submittal	<u>September 1989</u>
Environmental Assessment Submittal	<u>3 months after</u> notice of funding approval
Environmental Assessment Approval	<u> </u>
Begin Construction Plans	<u>1 - 1990</u>
File Plans	<u>4 - 1990</u>
Begin R/W Acquisition	<u>N/A</u>
Let Project	<u>7 - 1990</u>

Please mail this form to: Akron Metropolitan Area Transportation Study, 920 Society Bldg, 159 S. Main Street, Akron, Ohio 44308-1318.



AKRON METROPOLITAN AREA TRANSPORTATION STUDY

920 Society Building / 159 South Main Street / Akron, Ohio 44308-1318 / (216) 375-2436

June 30, 1988

Mr. Larry Wilson
Service Director
Village of Richfield
4410 S. Streetsboro Road
Richfield, Ohio 44286

Dear Mr. Wilson:

As discussed, enclosed please find a copy of a traffic count at the intersection of West Streetsboro Road (SR 303) and Broadview Road (SR 176). I have also enclosed copies of pages from the Ohio Manual of Uniform Traffic Control Devices discussing ways to discourage drivers from misusing the roadway shoulder.

I hope you find this information useful. If you have any questions, please call.

Very truly yours,

Todd Strauss
Engineer

TS:nlw

Enclosure

cc Mr. Hanson
Mr. Wang, ODOT District 4

10-21-87 50162

OHIO DEPARTMENT OF TRANSPORTATION
DIVISION OF TRANSPORTATION PLANNING
BUREAU OF TRANSPORTATION TECHNICAL SERVICES

PERIOD OF OBSERVATION 24-HOUR

YEAR COUNT WAS TAKEN 1987 STATION NUMBER 208A

LOG 02.54

COUNTY SUMMIT DISTRICT 04 CITY OR VILLAGE RICHFIELD
ROUTE 0176R INTERSECTION LOCATION SR176&SR303RICHFIELD&STREETSBO

TYPE VEHICLE OBSERVED TOTAL VEHICLE
TYPE VEHICLE OBSERVED PASS & TYPE A COM"L
TYPE VEHICLE OBSERVED TYPE B & C COM"L

NORTH LEG
SR176RICHFIELD

NORTH LEG
SR176RICHFIELD

NORTH LEG
SR176RICHFIELD

4226

4071

155

2153 + 2073

2077 + 1994

76 + 79

N TO W 423 + 452 E TO S
N TO S 1109 + 1754 E TO W
N TO E 621 + 678 E TO N

N TO W 412 + 440 E TO S
N TO S 1073 + 1687 E TO W
N TO E 592 + 652 E TO N

N TO W 11 + 12 E TO S
N TO S 36 + 67 E TO W
N TO E 29 + 26 E TO N

WEST LEG

EAST LEG

WEST LEG

EAST LEG

WEST LEG

EAST LEG

SR303STREETSBO

SR303STREETSBO

SR303STREETSBO

SR303STREETSBO

SR303STREETSBO

SR303STREETSBO

W TO S 450 + 409 S TO W
W TO E 1951 + 1057 S TO N
W TO N 338 + 494 S TO E

W TO S 433 + 400 S TO W
W TO E 1857 + 1016 S TO N
W TO N 326 + 480 S TO E

W TO S 17 + 9 S TO W
W TO E 94 + 41 S TO N
W TO N 12 + 14 S TO E

2011 + 1960

1946 + 1896

129

3971

3842

SR176RICHFIELD
SOUTH LEG

SR176RICHFIELD
SOUTH LEG

SR176RICHFIELD
SOUTH LEG

COUNTY: **Sumner** ROUTE: **0177BR** BUREAU OF TRANSPORTATION TECHNICAL SERVICES
 CITY OR VILLAGE: **Richfield** DENSITY COUNTS SHOWING TURNING MOVEMENTS
 INTERSECTION LOCATION: **SR1764SR303SR160R160R**

HOURS		N TO V		NORTH - LEG NAME		N TO S		SOUTH - LEG NAME		S TO E		S TO W		WEST - LEG NAME		WEST - LEG NAME		E TO S		E TO N		E TO V		E TO S		TOTAL VEHICLES		
FROM	TO	PASS	COML	PASS	COML	PASS	COML	PASS	COML	PASS	COML	PASS	COML	PASS	COML	PASS	COML	PASS	COML	PASS	COML	PASS	COML	PASS	COML			
7 AM	8 AM	6	-	64	3	34	-	19	2	76	2	23	-	21	1	227	11	34	3	32	1	56	5	16	1	637		
8 AM	9 AM	8	1	63	2	43	3	15	-	45	7	38	4	30	1	148	8	32	1	39	6	85	6	25	1	611		
9 AM	10 AM	5	-	48	3	22	4	23	2	42	9	32	-	10	1	91	6	22	3	26	5	46	7	31	2	440		
10 AM	11 AM	15	2	57	3	30	5	9	-	43	6	30	2	20	-	57	7	31	-	20	2	57	5	24	2	427		
2 PM	3 PM	40	-	74	6	50	4	22	-	67	1	41	1	24	2	105	7	22	1	41	1	67	1	22	-	599		
3 PM	4 PM	39	3	71	4	44	2	34	-	73	-	29	-	22	3	91	9	37	2	62	2	136	8	43	2	716		
4 PM	5 PM	47	-	94	3	37	-	43	2	79	2	27	-	24	-	108	3	26	1	58	-	187	2	47	-	790		
5 PM	6 PM	55	1	90	-	49	1	44	-	106	-	31	2	19	-	103	4	22	-	63	-	211	5	22	-	828		
8 HOUR TOTAL		215	7	561	24	309	19	209	6	531	27	251	9	170	8	930	55	226	11	341	17	845	39	230	8	5048		
24 HOUR FACTOR		1.84	1.50	1.84	1.50	1.84	1.50	1.84	1.50	1.84	1.50	1.84	1.50	1.84	1.50	1.84	1.71	1.84	1.50	1.84	1.50	1.84	1.71	1.84	1.50	1.84	1.50	9376
24 HOUR TOTAL		396	11	1032	36	569	29	385	9	977	41	462	14	313	12	1786	94	416	17	627	26	1622	67	423	12	9376		
ADJUSTED 24 HOUR TOTAL		412	11	1073	36	592	29	400	9	1016	41	480	14	326	12	1859	94	433	17	652	26	1687	67	440	12	9736		

LEGEND: PASS = PASSENGER CARS AND PANEL/PICK-UP TRUCKS
 COML = ALL OTHER COMMERCIAL VEHICLES
 FIELD SUPERVISOR: **DRY**
 INITIAL: **DRY** DATE: **7:55A 8:30A**
 SIGNATURE: **DRY** TIME: **2:00P 2:00P**
 DEPARTMENT: **DRY**

S.R. 303 West Bound

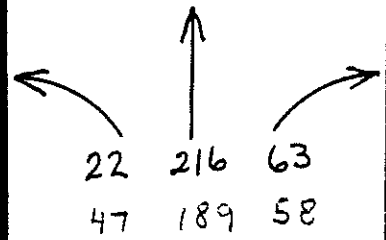

5-6 P.M.
4-5 P.M.

S.R. 303 East Bound

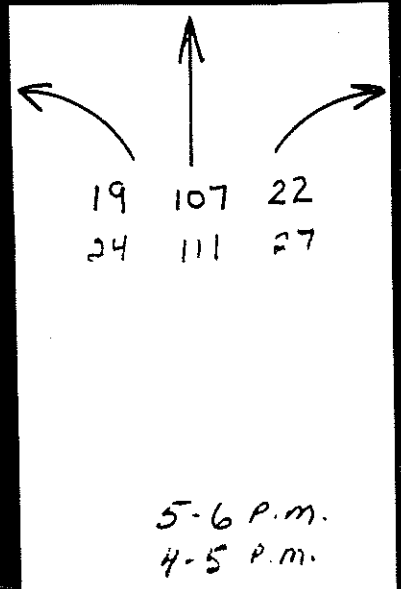

S.R. 176 South Bound

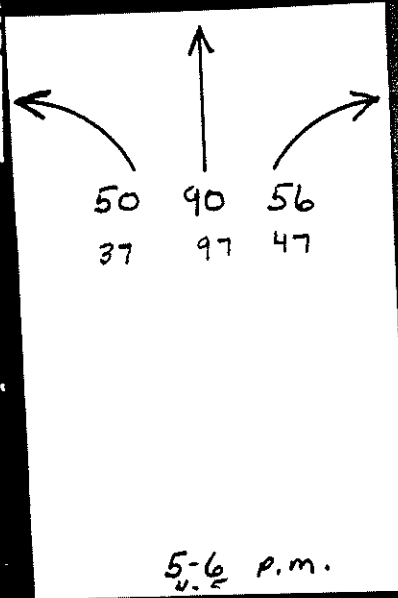

S.R. 176 North Bound

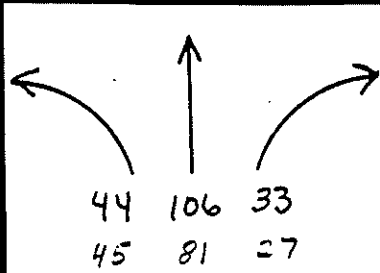

5-6 p.m.
4-5

VEHICULAR TRAFFIC AT THE INTERSECTION OF _____

By [unclear] 1597

1597

S.R. 303

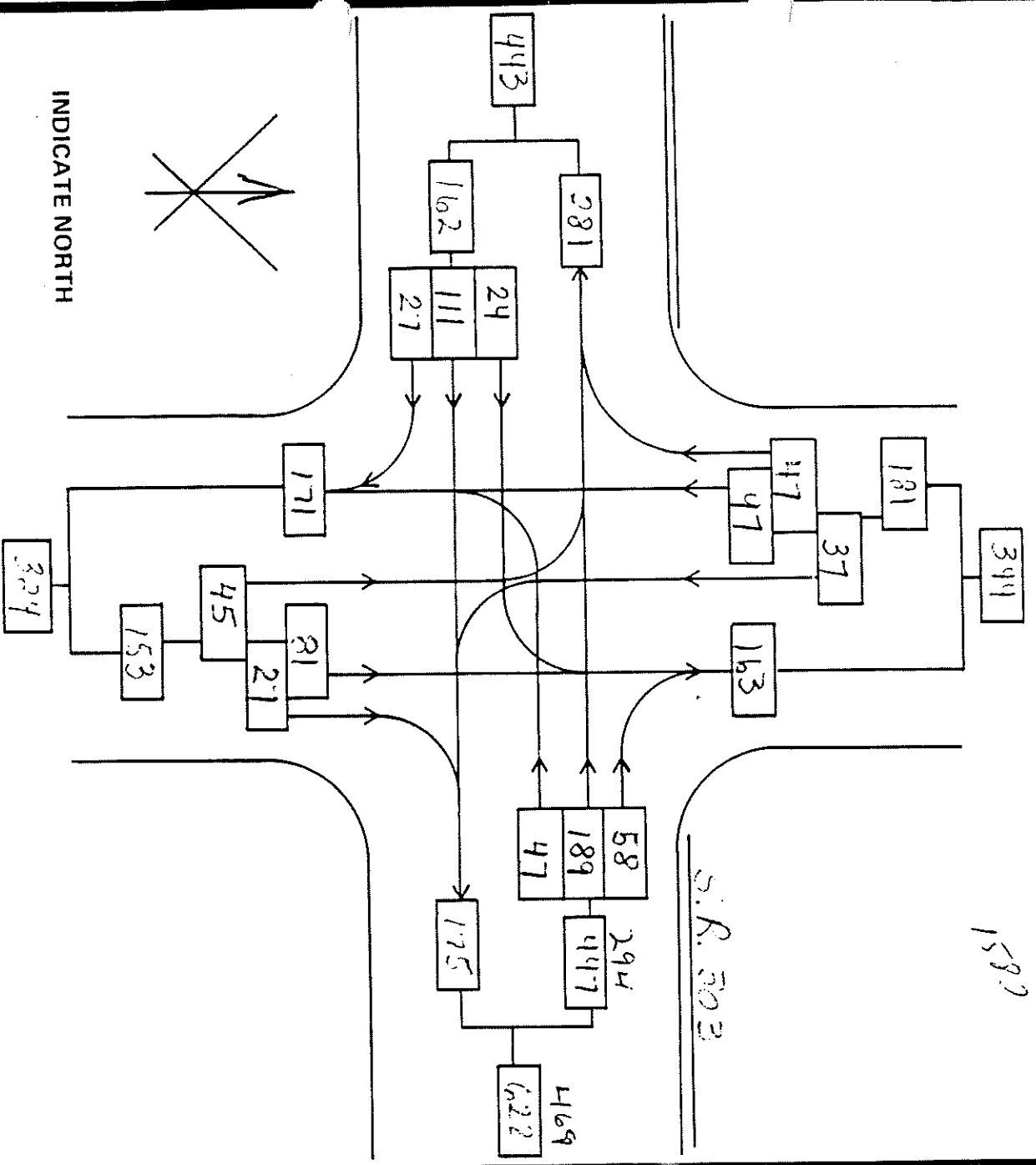

File Number _____

DAY _____

DATE _____

HOURS OF COUNT _____

PEAK HOUR _____

PEAK HOUR VOLUME _____

TOTAL VOLUME _____

% TRUCKS _____

HOURS PLOTTED 4-5 P.M.

FACTORS _____

Seasonal _____

24 Hour _____

NOTES _____
