



# TRAFFIC CRASH REPORT

\*DENOTES MANDATORY FIELD FOR SUPPLEMENT REPORT

LOCAL REPORT NUMBER\*

2020051

PHOTOS TAKEN     OH-2     OH-3  
 SECONDARY CRASH     OH-1P     OTHER  
 PRIVATE PROPERTY

LOCAL INFORMATION  
 REPORTING AGENCY NAME\*  
 RICHFIELD POLICE  
 NCIC\*  
 07726

HIT/SKIP  
 1 - SOLVED  
 2 - UNSOLVED  
 NUMBER OF UNITS  
 02  
 UNIT IN ERROR  
 99 - ANIMAL  
 99 - UNKNOWN

COUNTY\* 77    LOCALITY\* 2  
 1 - CITY  
 2 - VILLAGE  
 3 - TOWNSHIP  
 LOCATION: CITY, VILLAGE, TOWNSHIP\*  
 RICHFIELD

CRASH DATE / TIME\*  
 05/09/2020 06:23  
 CRASH SEVERITY  
 5  
 1 - FATAL  
 2 - SERIOUS INJURY SUSPECTED  
 3 - MINOR INJURY SUSPECTED  
 4 - INJURY POSSIBLE  
 5 - PROPERTY DAMAGE ONLY

ROUTE TYPE    ROUTE NUMBER    PREFIX  
 LOCATION ROAD NAME  
 I-77  
 ROAD TYPE  
 HW

LATITUDE DECIMAL DEGREES  
 41.259224

ROUTE TYPE    ROUTE NUMBER    PREFIX  
 REFERENCE ROAD NAME (ROAD, MILEPOST, HOUSE #)  
 145.8  
 ROAD TYPE  
 MP

LONGITUDE DECIMAL DEGREES  
 81.632821

REFERENCE POINT  
 1 - INTERSECTION  
 2 - MILE POST  
 3 - HOUSE #  
 2  
 DIRECTION FROM REFERENCE  
 N - NORTH  
 S - SOUTH  
 E - EAST  
 W - WEST  
 ROUTE TYPE  
 IR - INTERSTATE ROUTE (TP)  
 US - FEDERAL US ROUTE  
 SR - STATE ROUTE  
 CR - NUMBERED COUNTY ROUTE  
 TR - NUMBERED TOWNSHIP ROUTE  
 ROAD TYPE  
 AL - ALLEY    HW - HIGHWAY    RD - ROAD  
 AV - AVENUE    LA - LANE    SQ - SQUARE  
 BL - BOULEVARD    MP - MILEPOST    ST - STREET  
 CR - CIRCLE    OV - OVAL    TE - TERRACE  
 CT - COURT    PK - PARKWAY    TL - TRAIL  
 DR - DRIVE    PI - PIKE    WA - WAY  
 HE - HEIGHTS    PL - PLACE

INTERSECTION RELATED  
 WITHIN INTERSECTION OR ON APPROACH  
 WITHIN INTERCHANGE AREA    NUMBER OF APPROACHES  
 ROADWAY  
 ROADWAY DIVIDED

LOCATION OF FIRST HARMFUL EVENT  
 1 - ON ROADWAY  
 2 - ON SHOULDER  
 3 - IN MEDIAN  
 4 - ON ROADSIDE  
 5 - ON GORE  
 6 - OUTSIDE TRAFFIC WAY  
 7 - ON RAMP  
 8 - OFF RAMP  
 1  
 9 - CROSSOVER  
 10 - DRIVEWAY/ALLEY ACCESS  
 11 - RAILWAY GRADE CROSSING  
 12 - SHARED USE PATHS OR TRAILS  
 13 - BIKE LANE  
 14 - TOLL BOOTH  
 99 - OTHER / UNKNOWN

MANNER OF CRASH COLLISION/IMPACT  
 1 - NOT COLLISION BETWEEN TWO MOTOR VEHICLES IN TRANSPORT  
 2 - REAR-END  
 3 - HEAD-ON  
 4 - REAR-TO-REAR  
 5 - BACKING  
 6 - ANGLE  
 7 - SIDESWIPE, SAME DIRECTION  
 8 - SIDESWIPE, OPPOSITE DIRECTION  
 9 - OTHER / UNKNOWN  
 7

DIRECTION OF TRAVEL  
 N - NORTH  
 S - SOUTH  
 E - EAST  
 W - WEST  
 N  
 MEDIAN TYPE  
 1 - DIVIDED FLUSH MEDIAN (<4 FEET)  
 2 - DIVIDED FLUSH MEDIAN (≥4 FEET)  
 3 - DIVIDED, DEPRESSED MEDIAN  
 4 - DIVIDED, RAISED MEDIAN (ANY TYPE)  
 9 - OTHER/UNKNOWN  
 3

WORK ZONE RELATED  
 WORKERS PRESENT  
 LAW ENFORCEMENT PRESENT  
 ACTIVE SCHOOL ZONE

WORK ZONE TYPE  
 1 - LANE CLOSURE  
 2 - LANE SHIFT/CROSSOVER  
 3 - WORK ON SHOULDER OR MEDIAN  
 4 - INTERMITTENT OR MOVING WORK  
 5 - OTHER  
 5

LOCATION OF CRASH IN WORK ZONE  
 1 - BEFORE THE 1ST WORK ZONE WARNING SIGN  
 2 - ADVANCE WARNING AREA  
 3 - TRANSITION AREA  
 4 - ACTIVITY AREA  
 5 - TERMINATION AREA  
 4

CONTOUR  
 1 - STRAIGHT LEVEL  
 2 - STRAIGHT GRADE  
 3 - CURVE LEVEL  
 4 - CURVE GRADE  
 9 - OTHER/UNKNOWN  
 2

CONDITIONS  
 1 - DRY  
 2 - WET  
 3 - SNOW  
 4 - ICE  
 5 - SAND, MUD, DIRT, OIL, GRAVEL  
 6 - WATER (STANDING, MOVING)  
 7 - SLUSH  
 9 - OTHER/UNKNOWN  
 2

SURFACE  
 1 - CONCRETE  
 2 - BLACKTOP, BITUMINOUS, ASPHALT  
 3 - BRICK/BLOCK  
 4 - SLAG, GRAVEL, STONE  
 5 - DIRT  
 9 - OTHER/UNKNOWN  
 2

LIGHT CONDITION  
 1 - DAYLIGHT  
 2 - DAWN/DUSK  
 3 - DARK - LIGHTED ROADWAY  
 4 - DARK - ROADWAY NOT LIGHTED  
 5 - DARK - UNKNOWN ROADWAY LIGHTING  
 9 - OTHER / UNKNOWN  
 2

WEATHER  
 1 - CLEAR  
 2 - CLOUDY  
 3 - FOG, SMOG, SMOKE  
 4 - RAIN  
 5 - SLEET, HAIL  
 6 - SNOW  
 7 - SEVERE CROSSWINDS  
 8 - BLOWING SAND, SOIL, DIRT, SNOW  
 9 - FREEZING RAIN OR FREEZING DRIZZLE  
 99 - OTHER / UNKNOWN  
 6

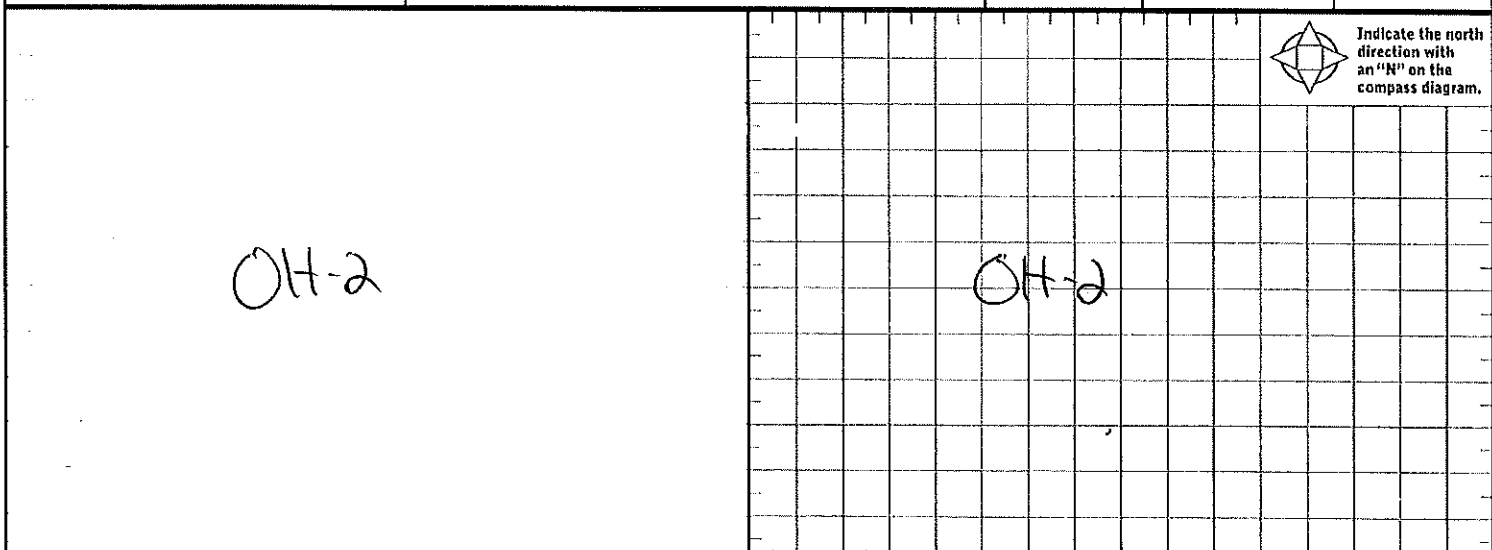

CRASH REPORTED DATE / TIME  
 05/09/2020 06:23

DISPATCH DATE / TIME  
 05/09/2020 06:30

ARRIVAL DATE / TIME  
 05/09/2020 06:36

SCENE CLEARED DATE / TIME  
 05/09/2020 07:53

REPORT TAKEN BY  
 POLICE AGENCY  
 MOTORIST

TOTAL TIME ROADWAY CLOSED  
 60

OTHER INVESTIGATION TIME  
 30

TOTAL MINUTES  
 113

OFFICER'S NAME\*  
 ANTHONY PADULA  
 OFFICER'S BADGE NUMBER\*  
 716

CHECKED BY OFFICER'S NAME\*  
 [Signature]  
 CHECKED BY OFFICER'S BADGE NUMBER\*  
 704

SUPPLEMENT (CORRECTION OR ADDITION TO AN EXISTING REPORT SENT TO CPD)

## OHIO TRAFFIC ACCIDENT - DIAGRAM/NARRATIVE CONTINUATION

OH - 2

LOCAL REPORT NUMBER 2020051	REPORTING AGENCY RICHFIELD POLICE	DATE OF ACCIDENT M 05 D 09 Y 2020
IN COUNTY OF SUMMIT	ACCIDENT LOCATION I-77	

Both Units were North bound on IR77 passing over the Brecksville Road overpass.  
 Unit 1 was in the right lane that old original paving.  
 Unit 2 was in the left lane that had been freshly paved except the approaches to the overpasses which are marked with signs stating BUMP.  
 Unit 1's driver said that she began to slide and hit the guard rail.  
 Unit 1 came to final rest in left lane facing south  
 Unit 2 came to final rest about 20 feet North of Unit 1 facing East.

It appears the left front of Unit 1 made contact with Unit 2's right bed side but it's unclear which vehicle was stuck and which was the striking.

Driver of Unit 2 later complained of back pain just before clearing scene but refused any treatment. Driver stated he would go to hospital later. He was then picked up by his boss for work.

Based on weather conditions, statements from drivers and no independent witnesses, it is undeterminable as to who is at fault in this crash.

	OFFICER'S SIGNATURE X	BADGE NUMBER 716
--	--------------------------	---------------------

HSY 7002 4/07

**UNIT #** 01 **OWNER NAME: LAST, FIRST, MIDDLE (SAME AS DRIVER)**  
 SPAULDING AMOS M  
**OWNER ADDRESS: STREET, CITY, STATE, ZIP (SAME AS DRIVER)**  
 1517 2ND ST NE CANTON OH 44704  
**COMMERCIAL CARRIER: NAME, ADDRESS, CITY, STATE, ZIP**  
**OWNER PHONE: INCLUDE AREA CODE (SAME AS DRIVER)**  
**COMMERCIAL CARRIER PHONE: INCLUDE AREA CODE**

**DAMAGE**  
**DAMAGE SCALE**  
 4 1 - NONE 3 - FUNCTIONAL DAMAGE  
 2 - MINOR DAMAGE 4 - DISABLING DAMAGE  
 9 - UNKNOWN

**LP STATE** OH **LICENSE PLATE #** FID8886 **VEHICLE IDENTIFICATION #** 3LNHM26T17R654144 **VEHICLE YEAR** 2007 **VEHICLE MAKE** LINC  
 **INSURANCE VERIFIED** **INSURANCE COMPANY** METROPOLITAN **INSURANCE POLICY #** 0394945141 **COLOR** TAN / **VEHICLE MODEL** MKL  
 **COMMERCIAL**  **GOVERNMENT**  **IN EMERGENCY RESPONSE** **US DOT #** **TOWED BY COMPANY NAME** WORLD  
 **INTERLOCK DEVICE EQUIPPED**  **HIT/SKIP UNIT** **#OCCUPANTS** 04 **VEHICLE WEIGHT GVWR/GCWR** 1 1 - <10K LBS. 2 - 10,001 - 26K LBS. 3 - >26K LBS. **HAZARDOUS MATERIAL**  **MATERIAL RELEASED**  **PLACARD**

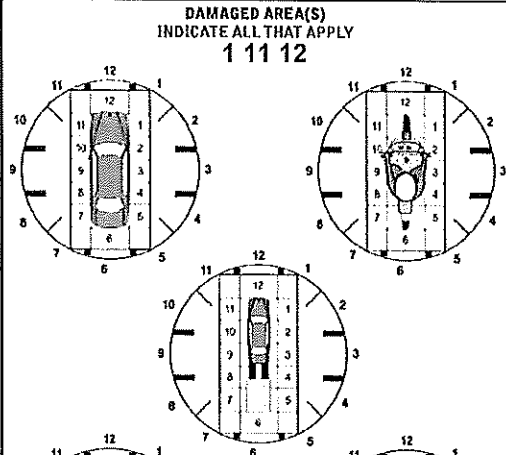

**UNIT TYPE** 1 1 - PASSENGER CAR 7 - MOTORCYCLE 2-WHEELED 12 - GOLF CART 18 - LIMO (LIVERY VEHICLE) 23 - PEDESTRIAN / SKATER  
 2 - PASSENGER VAN (MINIVAN) 8 - MOTORCYCLE 3-WHEELED 13 - SNOWMOBILE 19 - BUS (16+ PASSENGERS) 24 - WHEELCHAIR (ANY TYPE)  
 3 - SPORT UTILITY VEHICLE 9 - AUTOCYCLE 14 - SINGLE UNIT TRUCK 20 - OTHER VEHICLE 25 - OTHER NON-MOTORIST  
 4 - PICK UP 10 - MOPED OR MOTORIZED BICYCLE 15 - SEMI-TRACTOR 21 - HEAVY EQUIPMENT 26 - BICYCLE  
 5 - CARGO VAN 11 - ALL TERRAIN VEHICLE (ATV/UTV) 16 - FARM EQUIPMENT 22 - ANIMAL WITH RIDER OR ANIMAL-DRAWN VEHICLE 27 - TRAIN  
 6 - VAN (9-15 SEATS) 17 - MOTORHOME 99 - UNKNOWN OR HIT/SKIP

**# OF TRAILING UNITS**

**WAS VEHICLE OPERATING IN AUTONOMOUS MODE WHEN CRASH OCCURRED?** 2 1 - YES 2 - NO 9 - OTHER / UNKNOWN **AUTONOMOUS MODE LEVEL** 0 - NO AUTOMATION 1 - DRIVER ASSISTANCE 2 - PARTIAL AUTOMATION 3 - CONDITIONAL AUTOMATION 4 - HIGH AUTOMATION 5 - FULL AUTOMATION 9 - UNKNOWN

**SPECIAL FUNCTION** 1 1 - NONE 6 - BUS - CHARTER/TOUR 11 - FIRE 16 - FARM 21 - MAIL CARRIER  
 2 - TAXI 7 - BUS - INTERCITY 12 - MILITARY 17 - MOWING 99 - OTHER / UNKNOWN  
 3 - ELECTRONIC RIDE SHARING 8 - BUS - SHUTTLE 13 - POLICE 18 - SNOW REMOVAL  
 4 - SCHOOL TRANSPORT 9 - BUS - OTHER 14 - PUBLIC UTILITY 19 - TOWING  
 5 - BUS - TRANSIT/COMMUTER 10 - AMBULANCE 15 - CONSTRUCTION EQUIPMENT 20 - SAFETY SERVICE PATROL

**CARGO BODY TYPE** 1 1 - NO CARGO BODY TYPE / NOT APPLICABLE 3 - VEHICLE TOWING ANOTHER MOTOR VEHICLE 5 - INTERMODAL CONTAINER CHASSIS 8 - POLE 12 - CONCRETE MIXER  
 2 - BUS 4 - LOGGING 6 - CARGO VAN/ENCLOSED BOX 9 - CARGO TANK 13 - AUTO TRANSPORTER  
 7 - GRAIN/CHIPS/GRAVEL 10 - FLAT BED 14 - GARBAGE/REFUSE 19 - OTHER / UNKNOWN

**VEHICLE DEFECTS** 1 1 - TURN SIGNALS 4 - BRAKES 7 - WORN OR SLICK TIRES 9 - MOTOR TROUBLE 99 - OTHER / UNKNOWN  
 2 - HEAD LAMPS 5 - STEERING 8 - TRAILER EQUIPMENT DEFECTIVE 10 - DISABLED FROM PRIOR ACCIDENT  
 3 - TAIL LAMPS 6 - TIRE BLOWOUT

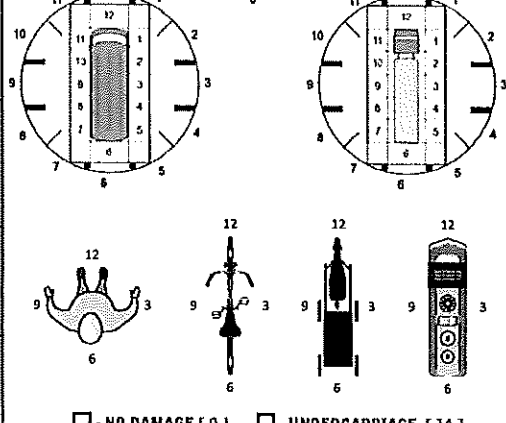

**NON-MOTORIST LOCATION AT IMPACT** 1 1 - INTERSECTION - MARKED CROSSWALK 3 - INTERSECTION - OTHER 6 - BICYCLE LAKE 9 - MEDIUM CROSSING ISLAND 12 - FIRST RESPONDER AT INCIDENT SCENE  
 2 - INTERSECTION - UNMARKED CROSSWALK 4 - MIDBLOCK - MARKED CROSSWALK 7 - SHOULDER / ROADSIDE 10 - DRIVEWAY ACCESS 14 - GARBAGE/REFUSE 19 - OTHER / UNKNOWN  
 5 - TRAVEL LANE - OTHER LOCATION 8 - SIDEWALK 11 - SHARED USE PATHS OR TRAILS

**ACTION** 9 1 - NON-CONTACT 1 - STRAIGHT AHEAD 7 - MAKING U-TURN 13 - NEGOTIATING A CURVE 18 - APPROACHING OR LEAVING VEHICLE  
 2 - NON-COLLISION 2 - BACKING 8 - ENTERING TRAFFIC LANE 14 - ENTERING OR CROSSING SPECIFIED LOCATION 19 - STANDING  
 3 - STRIKING 3 - CHANGING LANES 9 - LEAVING TRAFFIC LANE 15 - WALKING, RUNNING, JOGGING, PLAYING 20 - OTHER NON-MOTORIST  
 4 - STRUCK PRE-CRASH ACTIONS 4 - OVERTAKING/PASSING 10 - PARKED 11 - SLOWING OR STOPPED IN TRAFFIC 16 - WORKING 21 - STANDING OUTSIDE DISABLED VEHICLE  
 5 - BOTH STRIKING & STRUCK 5 - MAKING RIGHT TURN 11 - SLOWING OR STOPPED IN TRAFFIC 17 - PUSHING VEHICLE 99 - OTHER / UNKNOWN  
 9 - OTHER / UNKNOWN 6 - MAKING LEFT TURN 12 - DRIVERLESS 17 - PUSHING VEHICLE 99 - OTHER / UNKNOWN

**CONTRIBUTING CIRCUMSTANCES** 5 1 - NONE 7 - LEFT OF CENTER 13 - IMPROPER START FROM A PARKED POSITION 17 - VISION OBSTRUCTION 21 - LYING IN ROADWAY  
 2 - FAILURE TO YIELD 8 - FOLLOWING TOO CLOSE / ACDA 14 - STOPPED OR PARKED ILLEGALLY 18 - OPERATING DEFECTIVE EQUIPMENT 22 - HOT DISCERNIBLE  
 3 - RAN RED LIGHT 9 - IMPROPER LANE CHANGE 15 - SWERVING TO AVOID 19 - LOAD SHIFTING/FALLING/SPILLING 23 - OPENING DOOR INTO ROADWAY  
 4 - RAN STOP SIGN 10 - IMPROPER PASSING 16 - WRONG WAY 20 - IMPROPER CROSSING 99 - OTHER IMPROPER ACTION  
 5 - UNSAFE SPEED 11 - DROVE OFF ROAD 21 - PARKED MOTOR VEHICLE  
 6 - IMPROPER TURN 12 - IMPROPER BACKING

**INITIAL POINT OF CONTACT**  
 1 0 - NO DAMAGE 14 - UNDERCARRIAGE  
 1-12 - REFER TO UNIT DIAGRAM 15 - VEHICLE NOT AT SCENE  
 13 - TOP 99 - UNKNOWN

**TRAFFIC**

<b>TRAFFICWAY FLOW</b> 1 1 - ONE-WAY 2 - TWO-WAY	<b>TRAFFIC CONTROL</b> 6 1 - ROUNDABOUT 4 - STOP SIGN 2 - SIGNAL 5 - YIELD SIGN 3 - FLASHER 6 - NO CONTROL
<b># OF THROUGH LANES ON ROAD</b> 02	<b>RAIL GRADE CROSSING</b> 1 1 - NOT INVOLVED 2 - INVOLVED-ACTIVE CROSSING 3 - INVOLVED-PASSIVE CROSSING

**UNIT / NON-MOTORIST DIRECTION**  
 FROM 2 TO 1  
 1 - NORTH 5 - NORTHEAST  
 2 - SOUTH 6 - NORTHWEST  
 3 - EAST 7 - SOUTHWEST  
 4 - WEST 8 - SOUTHWEST  
 9 - OTHER / UNKNOWN

**UNIT SPEED** 60  
**POSTED SPEED** 60

**DETECTED SPEED** 1 1 - STATED / ESTIMATED SPEED  
 2 - CALCULATED / EDR  
 3 - UNDETERMINED

**SEQUENCE OF EVENTS**

1 20 1 - OVERTURN/ROLLOVER 6 - EQUIPMENT FAILURE 11 - CROSS CENTERLINE - OPPOSITE DIRECTION OF TRAVEL 16 - RAILWAY VEHICLE 22 - WORK ZONE MAINTENANCE EQUIPMENT  
 2 - FIRE/EXPLOSION 7 - SEPARATION OF UNITS 12 - DOWNHILL RUNAWAY 17 - ANIMAL - FARM 23 - STRUCK BY FALLING, SHIFTING CARGO OR ANYTHING SET IN MOTION BY A MOTOR VEHICLE  
 3 - IMMERSION 8 - RAN OFF ROAD RIGHT 13 - OTHER NON-COLLISION 18 - ANIMAL - DEER 24 - OTHER MOVABLE OBJECT  
 4 - JACKKNIFE 9 - RAN OFF ROAD LEFT 14 - PEDESTRIAN 19 - ANIMAL - OTHER 20 - MOTOR VEHICLE IN TRANSPORT  
 5 - CARGO / EQUIPMENT LOSS OR SHIFT 10 - CROSS MEDIAN 15 - PEDALCYCLE 21 - PARKED MOTOR VEHICLE

**COLLISION WITH FIXED OBJECT - STRUCK**

4 25 - IMPACT ATTENUATOR / CRASH CUSHION 31 - GUARDRAIL END 37 - TRAFFIC SIGN POST 43 - CURB 50 - WORK ZONE MAINTENANCE EQUIPMENT  
 26 - BRIDGE OVERHEAD STRUCTURE 32 - PORTABLE BARRIER 38 - OVERHEAD SIGN POST 44 - DITCH 51 - WALL  
 5 27 - BRIDGE PIER OR ABUTMENT 33 - MEDIUM CABLE BARRIER 39 - LIGHT / LUMINARIES SUPPORT 45 - EMBANKMENT 52 - BUILDING  
 28 - BRIDGE PARAPET 34 - MEDIUM GUARDRAIL BARRIER 40 - UTILITY POLE 46 - FENCE 53 - TUNNEL  
 6 29 - BRIDGE RAIL 35 - MEDIUM CONCRETE BARRIER 41 - OTHER POST POLE OR SUPPORT 47 - MAIL BOX 54 - OTHER FIXED OBJECT  
 30 - GUARDRAIL FACE 36 - MEDIUM OTHER BARRIER 42 - CULVERT 48 - TREE 99 - OTHER / UNKNOWN  
 49 - FIRE HYDRANT

1 1 **FIRST HARMFUL EVENT** 1 **MOST HARMFUL EVENT**

**UNIT #** 02 **OWNER NAME:** LAST, FIRST, MIDDLE (SAVE AS DRIVER) **OWNER PHONE:** INCLUDE AREA CODE (SAME AS DRIVER) 330-212-9560  
**STIEBER MICHAEL T**  
**OWNER ADDRESS:** STREET, CITY, STATE, ZIP (SAME AS DRIVER) 3557 KNOLLWOOD LN AKRON OH 44333  
**COMMERCIAL CARRIER:** NAME, ADDRESS, CITY, STATE, ZIP **COMMERCIAL CARRIER PHONE:** INCLUDE AREA CODE

**LP STATE** OH **LICENSE PLATE #** PKW7563 **VEHICLE IDENTIFICATION #** 3D7KS28L69G518545 **VEHICLE YEAR** 2009 **VEHICLE MAKE** DODG  
 **INSURANCE VERIFIED** **INSURANCE COMPANY** **INSURANCE POLICY #** **COLOR** BLK / **VEHICLE MODEL** RAM  
 **COMMERCIAL** **TYPE OF USE**  **GOVERNMENT**  **IN EMERGENCY RESPONSE** **US DOT #** **TOWED BY COMPANY NAME** WORLD  
 **INTERLOCK DEVICE EQUIPPED**  **HIT/SKIP UNIT** **#OCCUPANTS** 01 **VEHICLE WEIGHT GVWR/GCWR** 1 2 3  
 1 - ≤10K LBS. 2 - 10,001 - 26K LBS. 3 - >26K LBS. **HAZARDOUS MATERIAL**  
 **MATERIAL RELEASED** **CLASS #** **PLACARD ID #**  **PLACARD**

**UNIT TYPE** 4  
 1 - PASSENGER CAR 7 - MOTORCYCLE 2-WHEELED 12 - GOLF CART 18 - LIMO (LIVERY VEHICLE) 23 - PEDESTRIAN / SKATER  
 2 - PASSENGER VAN (MINIVAN) 8 - MOTORCYCLE 3-WHEELED 13 - SNOWMOBILE 19 - BUS (16+ PASSENGERS) 24 - WHEELCHAIR (ANY TYPE)  
 3 - SPORT UTILITY VEHICLE 9 - AUTOCYCLE 14 - SINGLE UNIT TRUCK 20 - OTHER VEHICLE 25 - OTHER NON-MOTORIST  
 4 - PICK UP 10 - MOPED OR MOTORIZED BICYCLE 15 - SEMI-TRACTOR 21 - HEAVY EQUIPMENT 26 - BICYCLE  
 5 - CARGO VAN 11 - ALL TERRAIN VEHICLE (ATV/UTV) 16 - FARM EQUIPMENT 22 - ANIMAL WITH RIDER OR ANIMAL-DRAWN VEHICLE 27 - TRAIN  
 6 - VAN (9-15 SEATS) 17 - MOTORHOME

**WAS VEHICLE OPERATING IN AUTONOMOUS MODE WHEN CRASH OCCURRED?** 2  
 1 - YES 2 - NO 9 - OTHER / UNKNOWN **AUTONOMOUS MODE LEVEL**  
 0 - NO AUTOMATION 1 - DRIVER ASSISTANCE 2 - PARTIAL AUTOMATION 3 - CONDITIONAL AUTOMATION 4 - HIGH AUTOMATION 5 - FULL AUTOMATION 9 - UNKNOWN  
**SPECIAL FUNCTION** 1  
 1 - NONE 2 - TAXI 3 - ELECTRONIC RIDE SHARING 4 - SCHOOL TRANSPORT 5 - BUS - TRANSIT/COMMUTER  
 6 - BUS - CHARTER/TOUR 7 - BUS - INTERCITY 8 - BUS - SHUTTLE 9 - BUS - OTHER 10 - AMBULANCE  
 11 - FIRE 12 - MILITARY 13 - POLICE 14 - PUBLIC UTILITY 15 - CONSTRUCTION EQUIPMENT 16 - FARM 17 - MOWING 18 - SHOW REMOVAL 19 - TOWING 20 - SAFETY SERVICE PATROL 21 - MAIL CARRIER 99 - OTHER / UNKNOWN

**CARGO BODY TYPE** 1  
 1 - NO CARGO BODY TYPE / NOT APPLICABLE 2 - BUS 3 - VEHICLE TOWING ANOTHER MOTOR VEHICLE 4 - LOGGING 5 - INTERMODAL CONTAINER CHASSIS 6 - CARGO VAN/ENCLOSED BOX 7 - GRAIN/CHIPS/GRAVEL 8 - POLE 9 - CARGO TANK 10 - FLAT BED 11 - DUMP 12 - CONCRETE MIXER 13 - AUTO TRANSPORTER 14 - GARBAGE/REFUSE 99 - OTHER / UNKNOWN  
**VEHICLE DEFECTS**  
 1 - TURN SIGNALS 2 - HEAD LAMPS 3 - TAIL LAMPS 4 - BRAKES 5 - STEERING 6 - TIRE BLOWOUT 7 - WORN OR SLICK TIRES 8 - TRAILER EQUIPMENT DEFECTIVE 9 - MOTOR TROUBLE 10 - DISABLED FROM PRIOR ACCIDENT 99 - OTHER / UNKNOWN

**NON-MOTORIST LOCATION AT IMPACT**  
 1 - INTERSECTION - MARKED CROSSWALK 2 - INTERSECTION - UNMARKED CROSSWALK 3 - INTERSECTION - OTHER 4 - MIDBLOCK - MARKED CROSSWALK 5 - TRAVEL LANE - OTHER LOCATION 6 - BICYCLE LANE 7 - SHOULDER / ROADSIDE 8 - SIDEWALK 9 - MEDIAN/CROSSING ISLAND 10 - DRIVEWAY ACCESS 11 - SHARED USE PATHS OR TRAILS 12 - FIRST RESPONDER AT INCIDENT SCENE 99 - OTHER / UNKNOWN  
**ACTION** 9  
 1 - NON-CONTACT 2 - NON-COLLISION 3 - STRIKING 4 - STRUCK 5 - BOTH STRIKING & STRUCK 9 - OTHER / UNKNOWN 1 - STRAIGHT AHEAD 2 - BACKING 3 - CHANGING LANES 4 - OVERTAKING/PASSING 5 - MAKING RIGHT TURN 6 - MAKING LEFT TURN 7 - MAKING U-TURN 8 - ENTERING TRAFFIC LANE 9 - LEAVING TRAFFIC LANE 10 - PARKED 11 - SLOWING OR STOPPED IN TRAFFIC 12 - DRIVERLESS 13 - NEGOTIATING A CURVE 14 - ENTERING OR CROSSING SPECIFIED LOCATION 15 - WALKING, RUNNING, JOGGING, PLAYING 16 - WORKING 17 - PUSHING VEHICLE 18 - APPROACHING OR LEAVING VEHICLE 19 - STANDING 20 - OTHER NON-MOTORIST 21 - STANDING OUTSIDE DISABLED VEHICLE 99 - OTHER / UNKNOWN

**CONTRIBUTING CIRCUMSTANCES** 1  
 1 - NONE 2 - FAILURE TO YIELD 3 - RAN RED LIGHT 4 - RAN STOP SIGN 5 - UNSAFE SPEED 6 - IMPROPER TURN 7 - LEFT OF CENTER 8 - FOLLOWING TOO CLOSE / ACDA 9 - IMPROPER LANE CHANGE 10 - IMPROPER PASSING 11 - DROVE OFF ROAD 12 - IMPROPER BACKING 13 - IMPROPER START FROM A PARKED POSITION 14 - STOPPED OR PARKED ILLEGALLY 15 - SWERVING TO AVOID 16 - WRONG WAY 17 - VISION OBSTRUCTION 18 - OPERATING DEFECTIVE EQUIPMENT 19 - LOAD SHIFTING/FALLING/SPILLING 20 - IMPROPER CROSSING 21 - LYING IN ROADWAY 22 - NOT DISCERNIBLE 23 - OPENING DOOR INTO ROADWAY 99 - OTHER IMPROPER ACTION

**SEQUENCE OF EVENTS**  
 1 20  
 1 - OVERTURN/ROLLOVER 2 - FIRE/EXPLOSION 3 - IMMERSION 4 - JACKKNIFE 5 - CARGO/EQUIPMENT LOSS OR SHIFT 6 - EQUIPMENT FAILURE 7 - SEPARATION OF UNITS 8 - RAN OFF ROAD RIGHT 9 - RAN OFF ROAD LEFT 10 - CROSS MEDIAN 11 - CROSS CENTERLINE - OPPOSITE DIRECTION OF TRAVEL 12 - DOWNHILL RUNAWAY 13 - OTHER NON-COLLISION 14 - PEDESTRIAN 15 - PEDALCYCLE 16 - RAILWAY VEHICLE 17 - ANIMAL - FARM 18 - ANIMAL - DEER 19 - ANIMAL - OTHER 20 - MOTOR VEHICLE IN TRANSPORT 21 - PARKED MOTORVEHICLE 22 - WORK ZONE MAINTENANCE EQUIPMENT 23 - STRUCK BY FALLING, SHIFTING CARGO OR ANYTHING SET IN MOTION BY A MOTORVEHICLE 24 - OTHER MOVABLE OBJECT 25 - IMPACT ATTENUATOR / CRASH CUSHION 26 - BRIDGE OVERHEAD STRUCTURE 27 - BRIDGE PIER OR ABUTMENT 28 - BRIDGE PARAPET 29 - BRIDGE RAIL 30 - GUARDRAIL FACE 31 - GUARDRAIL END 32 - PORTABLE BARRIER 33 - MEDIUM CABLE BARRIER 34 - MEDIUM GUARDRAIL BARRIER 35 - MEDIUM CONCRETE BARRIER 36 - MEDIUM OTHER BARRIER 37 - TRAFFIC SIGN POST 38 - OVERHEAD SIGN POST 39 - LIGHT / LUMINARIES SUPPORT 40 - UTILITY POLE 41 - OTHER POST POLE OR SUPPORT 42 - CULVERT 50 - WORK ZONE MAINTENANCE EQUIPMENT 51 - WALL 52 - BUILDING 53 - TUNNEL 54 - OTHER FIXED OBJECT 99 - OTHER / UNKNOWN  
**FIRST HARMFUL EVENT** 1 **MOST HARMFUL EVENT** 1

**LOCAL REPORT NUMBER**  
 2020051

**DAMAGE**  
**DAMAGE SCALE**  
 4 1 - NONE 2 - MINOR DAMAGE 3 - FUNCTIONAL DAMAGE 4 - DISABLING DAMAGE 9 - UNKNOWN

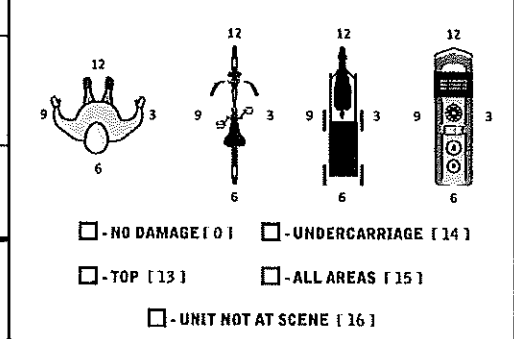
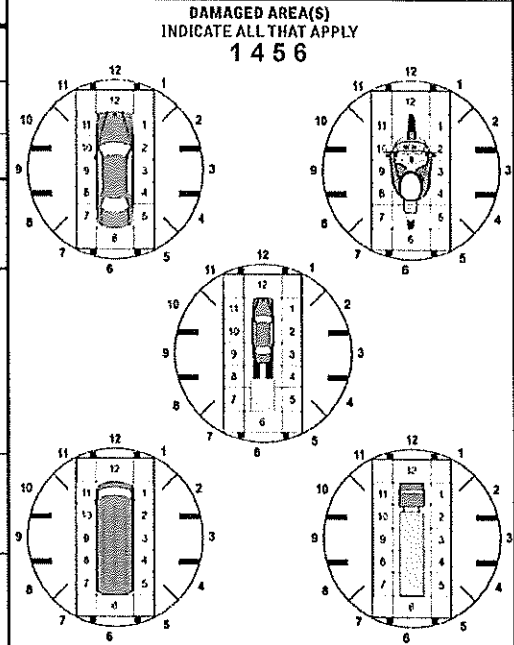

**INITIAL POINT OF CONTACT**  
 4 0 - NO DAMAGE 1 - 12 - REFER TO UNIT DIAGRAM 14 - UNDERCARRIAGE 15 - VEHICLE NOT AT SCENE 99 - UNKNOWN 13 - TOP

**TRAFFIC**  
**TRAFFICWAY FLOW** 1  
 1 - ONE-WAY 2 - TWO-WAY  
**TRAFFIC CONTROL** 6  
 1 - ROUNDABOUT 2 - SIGNAL 3 - FLASHER 4 - STOP SIGN 5 - YIELD SIGN 6 - NO CONTROL  
**# OF THROUGH LANES ON ROAD** 02  
**RAIL GRADE CROSSING** 1  
 1 - NOT INVOLVED 2 - INVOLVED-ACTIVE CROSSING 3 - INVOLVED-PASSIVE CROSSING

**UNIT / NON-MOTORIST DIRECTION**  
 FROM 2 TO 1  
 1 - NORTH 2 - SOUTH 3 - EAST 4 - WEST 5 - NORTHEAST 6 - NORTHWEST 7 - SOUTHEAST 8 - SOUTHWEST 9 - OTHER / UNKNOWN

**UNIT SPEED** 55  
**POSTED SPEED** 60  
**DETECTED SPEED** 1  
 1 - STATED / ESTIMATED SPEED 2 - CALCULATED / EOR 3 - UNDETERMINED



# MOTORIST / Non-MOTORIST

LOCAL REPORT NUMBER  
2020051

UNIT # 01	NAME: LAST, FIRST, MIDDLE SPAULDING NIA SHANELL	DATE OF BIRTH 08/05/2001	AGE 18	GENDER F
ADDRESS: STREET, CITY, STATE, ZIP 712 18TH ST NE CANTON OH 44714		CONTACT PHONE - INCLUDE AREA CODE 330-417-7790		
INJURIES 5	INJURED TAKEN BY 1	EMS AGENCY (NAME)	INJURED TAKEN TO: MEDICAL FACILITY (NAME, CITY)	SAFETY EQUIPMENT USED 4
OL STATE OH	OPERATOR LICENSE NUMBER UW185509	OFFENSE CHARGED		LOCAL CODE <input type="checkbox"/>
OL CLASS 4	ENDORSEMENT	RESTRICTION select up to 3 3	DRIVER DISTRACTED BY 1	ALCOHOL / DRUG SUSPECTED <input type="checkbox"/> ALCOHOL <input type="checkbox"/> MARIJUANA <input type="checkbox"/> OTHER DRUG
OFFENSE DESCRIPTION		CITATION NUMBER		
DOT-COMPLIANT MC HELMET <input type="checkbox"/>		SEATING POSITION 1	AIR BAG USAGE 1	EJECTION 1
TRAPPED 1				

UNIT # 02	NAME: LAST, FIRST, MIDDLE STIEBER MICHAEL T	DATE OF BIRTH 12/29/1987	AGE 32	GENDER M
ADDRESS: STREET, CITY, STATE, ZIP 3557 KNOLLWOOD LN AKRON OH 44333		CONTACT PHONE - INCLUDE AREA CODE 330-212-9560		
INJURIES 5	INJURED TAKEN BY 1	EMS AGENCY (NAME)	INJURED TAKEN TO: MEDICAL FACILITY (NAME, CITY)	SAFETY EQUIPMENT USED 4
OL STATE OH	OPERATOR LICENSE NUMBER SS940379	OFFENSE CHARGED		LOCAL CODE <input type="checkbox"/>
OL CLASS 4	ENDORSEMENT	RESTRICTION select up to 3	DRIVER DISTRACTED BY 1	ALCOHOL / DRUG SUSPECTED <input type="checkbox"/> ALCOHOL <input type="checkbox"/> MARIJUANA <input type="checkbox"/> OTHER DRUG
OFFENSE DESCRIPTION		CITATION NUMBER		
DOT-COMPLIANT MC HELMET <input type="checkbox"/>		SEATING POSITION 1	AIR BAG USAGE 1	EJECTION 1
TRAPPED 1				

UNIT #	NAME: LAST, FIRST, MIDDLE	DATE OF BIRTH //	AGE	GENDER
ADDRESS: STREET, CITY, STATE, ZIP		CONTACT PHONE - INCLUDE AREA CODE		
INJURIES	INJURED TAKEN BY	EMS AGENCY (NAME)	INJURED TAKEN TO: MEDICAL FACILITY (NAME, CITY)	SAFETY EQUIPMENT USED
OL STATE	OPERATOR LICENSE NUMBER	OFFENSE CHARGED		LOCAL CODE
OL CLASS	ENDORSEMENT	RESTRICTION select up to 3	DRIVER DISTRACTED BY	ALCOHOL / DRUG SUSPECTED
OFFENSE DESCRIPTION		CITATION NUMBER		
DOT-COMPLIANT MC HELMET		SEATING POSITION	AIR BAG USAGE	EJECTION
TRAPPED				

INJURIES	SEATING POSITION	AIR BAG	OL CLASS	OL RESTRICTION(S)	DRIVER DISTRACTION	TEST STATUS
1 - FATAL	1 - FRONT - LEFT SIDE (MOTORCYCLE DRIVER)	1 - NOT DEPLOYED	1 - CLASS A	1 - ALCOHOL INTERLOCK DEVICE	1 - NOT DISTRACTED	1 - NONE GIVEN
2 - SUSPECTED SERIOUS INJURY	2 - FRONT - MIDDLE	2 - DEPLOYED FRONT	2 - CLASS B	2 - CDL INTRASTATE ONLY	2 - MANUALLY OPERATING AN ELECTRONIC COMMUNICATION DEVICE (TEXTING, TYPING, DIALING)	2 - TEST REFUSED
3 - SUSPECTED MINOR INJURY	3 - FRONT - RIGHT SIDE	3 - DEPLOYED SIDE	3 - CLASS C	3 - CORRECTIVE LENSES	3 - TALKING ON HANDS-FREE COMMUNICATION DEVICE	3 - TEST GIVEN, CONTAMINATED SAMPLE / UNUSABLE
4 - POSSIBLE INJURY	4 - SECOND - LEFT SIDE (MOTORCYCLE PASSENGER)	4 - DEPLOYED BOTH FRONT / SIDE	4 - REGULAR CLASS (OHIO = D)	4 - FARM WAIVER	4 - TALKING ON HAND-HELD COMMUNICATION DEVICE	4 - TEST GIVEN, RESULTS KNOWN
5 - NO APPARENT INJURY	5 - SECOND - MIDDLE	5 - NOT APPLICABLE	5 - M/C MOPED ONLY	5 - EXCEPT CLASS A BUS	5 - OTHER ACTIVITY WITH AN ELECTRONIC DEVICE	5 - TEST GIVEN, RESULTS UNKNOWN
INJURED TAKEN BY		9 - DEPLOYMENT UNKNOWN	6 - NO VALID OL	6 - EXCEPT CLASS A & CLASS B BUS	7 - OTHER DISTRACTION INSIDE THE VEHICLE	5 - OTHER
1 - NOT TRANSPORTED / TREATED AT SCENE	6 - SECOND - RIGHT SIDE	EJECTION		7 - EXCEPT TRACTOR-TRAILER	8 - OTHER DISTRACTION OUTSIDE THE VEHICLE	ALCOHOL TEST TYPE
2 - EMS	7 - THIRD - LEFT SIDE (MOTORCYCLE SIDE CAR)	1 - NOT EJECTED	H - HAZMAT	8 - INTERMEDIATE LICENSE RESTRICTIONS	9 - OTHER / UNKNOWN	1 - NONE
3 - POLICE	8 - THIRD - MIDDLE	2 - PARTIALLY EJECTED	M - MOTORCYCLE	9 - LEARNER'S PERMIT RESTRICTIONS	10 - LIMITED TO DAYLIGHT ONLY	2 - BLOOD
9 - OTHER / UNKNOWN	9 - THIRD - RIGHT SIDE	3 - TOTALLY EJECTED	P - PASSENGER	11 - LIMITED TO EMPLOYMENT	11 - LIMITED TO EMPLOYMENT	3 - URINE
SAFETY EQUIPMENT		4 - NOT APPLICABLE	N - TANKER	12 - LIMITED - OTHER	12 - LIMITED - OTHER	4 - BREATH
1 - NONE USED	11 - PASSENGER IN OTHER ENCLOSED CARGO AREA (NON-TRAILING UNIT, BUS, PICK-UP WITH CAP)	TRAPPED		13 - MECHANICAL DEVICES (SPECIAL BRAKES, HAND CONTROLS, OR OTHER ADAPTIVE DEVICES)	13 - MECHANICAL DEVICES (SPECIAL BRAKES, HAND CONTROLS, OR OTHER ADAPTIVE DEVICES)	5 - OTHER
2 - SHOULDER BELT ONLY USED	12 - PASSENGER IN UNENCLOSED CARGO AREA	1 - NOT TRAPPED	Q - MOTOR SCOOTER	14 - MILITARY VEHICLES ONLY	14 - MILITARY VEHICLES ONLY	DRUG TEST TYPE
3 - LAP BELT ONLY USED	13 - TRAILING UNIT	2 - EXTRICATED BY MECHANICAL MEANS	R - THREE-WHEEL MOTORCYCLE	15 - MOTOR VEHICLES WITHOUT AIR BRAKES	15 - MOTOR VEHICLES WITHOUT AIR BRAKES	1 - NONE
4 - SHOULDER & LAP BELT USED	14 - RIDING ON VEHICLE EXTERIOR (NON-TRAILING UNIT)	3 - FREED BY NON-MECHANICAL MEANS	S - SCHOOL BUS	16 - OUTSIDE MIRROR	16 - OUTSIDE MIRROR	2 - BLOOD
5 - CHILD RESTRAINT SYSTEM - FORWARD FACING	15 - NON-MOTORIST		T - DOUBLE & TRIPLE TRAILERS	17 - PROSTHETIC AID	17 - PROSTHETIC AID	3 - URINE
6 - CHILD RESTRAINT SYSTEM - REAR FACING	99 - OTHER / UNKNOWN		X - TANKER / HAZMAT	18 - OTHER	18 - OTHER	4 - OTHER
7 - BOOSTER SEAT						DRUG TEST RESULT(S)
8 - HELMET USED						1 - AMPHETAMINES
9 - PROTECTIVE PADS USED (ELBOW, KNEES, ETC.)						2 - BARBITURATES
10 - REFLECTIVE CLOTHING						3 - BENZODIAZEPINES
11 - LIGHTING - PEDESTRIAN / BICYCLE ONLY						4 - CANNABINOIDS
99 - OTHER / UNKNOWN						5 - COCAINE
						6 - OPIATES / OPIOIDS
						7 - OTHER
						8 - NEGATIVE RESULTS

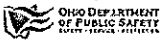

# OCCUPANT / WITNESS ADDENDUM

LOCAL REPORT NUMBER  
2020051

<b>OCCUPANT</b>	UNIT #	NAME: LAST, FIRST, MIDDLE				DATE OF BIRTH		AGE	GENDER	
	01	LUCIUS KYARA L				09/23/2001		18	F	
ADDRESS: STREET, CITY, STATE, ZIP					CONTACT PHONE - INCLUDE AREA CODE					
2253 15TH ST NE CANTON OH 44705					330-481-7140					
INJURIES	INJURED TAKEN BY	EMS AGENCY (NAME)	INJURED TAKEN TO: MEDICAL FACILITY (NAME, CITY)	SAFETY EQUIPMENT USED	<input type="checkbox"/> DOT-COMPLIANT MC HELMET	SEATING POSITION	AIR BAG USAGE	EJECTION	TRAPPED	
5	1			4		3	1	1	1	

<b>OCCUPANT</b>	UNIT #	NAME: LAST, FIRST, MIDDLE				DATE OF BIRTH		AGE	GENDER	
	01	SPAULDING BRIANNA DANIELLE				02/16/1997		23	F	
ADDRESS: STREET, CITY, STATE, ZIP					CONTACT PHONE - INCLUDE AREA CODE					
712 18TH ST NE CANTON OH 44714					330-413-1494					
INJURIES	INJURED TAKEN BY	EMS AGENCY (NAME)	INJURED TAKEN TO: MEDICAL FACILITY (NAME, CITY)	SAFETY EQUIPMENT USED	<input type="checkbox"/> DOT-COMPLIANT MC HELMET	SEATING POSITION	AIR BAG USAGE	EJECTION	TRAPPED	
5	1			4		4	1	1	1	

<b>OCCUPANT</b>	UNIT #	NAME: LAST, FIRST, MIDDLE				DATE OF BIRTH		AGE	GENDER	
	01	STOKES ALEAKA TAMIRA				03/25/2001		19	F	
ADDRESS: STREET, CITY, STATE, ZIP					CONTACT PHONE - INCLUDE AREA CODE					
2323 3RD ST SE CANTON OH 44707					234-521-9657					
INJURIES	INJURED TAKEN BY	EMS AGENCY (NAME)	INJURED TAKEN TO: MEDICAL FACILITY (NAME, CITY)	SAFETY EQUIPMENT USED	<input type="checkbox"/> DOT-COMPLIANT MC HELMET	SEATING POSITION	AIR BAG USAGE	EJECTION	TRAPPED	
5	1			4		6	1	1	1	

<b>OCCUPANT</b>	UNIT #	NAME: LAST, FIRST, MIDDLE				DATE OF BIRTH		AGE	GENDER	
ADDRESS: STREET, CITY, STATE, ZIP					CONTACT PHONE - INCLUDE AREA CODE					
INJURIES	INJURED TAKEN BY	EMS AGENCY (NAME)	INJURED TAKEN TO: MEDICAL FACILITY (NAME, CITY)	SAFETY EQUIPMENT USED	<input type="checkbox"/> DOT-COMPLIANT MC HELMET	SEATING POSITION	AIR BAG USAGE	EJECTION	TRAPPED	

INJURIES	SAFETY EQUIPMENT USED	SEATING POSITION	AIR BAG USAGE
1 - FATAL	1 - NONE USED - VEHICLE OCCUPANT	1 - FRONT - LEFT SIDE (MOTORCYCLE DRIVER)	1 - NOT DEPLOYED
2 - SUSPECTED SERIOUS INJURY	2 - SHOULDER BELT ONLY USED	2 - FRONT - MIDDLE	2 - DEPLOYED FRONT
3 - SUSPECTED MINOR INJURY	3 - LAP BELT ONLY USED	3 - FRONT - RIGHT SIDE	3 - DEPLOYED SIDE
4 - POSSIBLE INJURY	4 - SHOULDER & LAP BELT USED	4 - SECOND - LEFT SIDE (MOTORCYCLE PASSENGER)	4 - DEPLOYED BOTH FRONT/SIDE
5 - NO APPARENT INJURY	5 - CHILD RESTRAINT SYSTEM - FORWARD FACING	5 - SECOND - MIDDLE	5 - NOT APPLICABLE
	6 - CHILD RESTRAINT SYSTEM - REAR FACING	6 - SECOND - RIGHT SIDE	9 - DEPLOYMENT UNKNOWN
	7 - BOOSTER SEAT	7 - THIRD - LEFT SIDE (MOTORCYCLE SIDE CAR)	
	8 - HELMET USED	8 - THIRD - MIDDLE	
	9 - PROTECTIVE PADS USED (ELBOW, KNEES, ETC.)	9 - THIRD - RIGHT SIDE	
	10 - REFLECTIVE CLOTHING	10 - SLEEPER SECTION OF TRUCK CAB	
	11 - LIGHTING - PEDESTRIAN / BICYCLE ONLY	11 - PASSENGER IN OTHER ENCLOSED CARGO AREA (NON-TRAILING UNIT, BUS, PICK-UP WITH CAP)	
	99 - OTHER / UNKNOWN	12 - PASSENGER IN UNENCLOSED CARGO AREA	
		13 - TRAILING UNIT	
		14 - RIDING ON VEHICLE EXTERIOR (NON-TRAILING UNIT)	
		15 - NON-MOTORIST	
		99 - OTHER / UNKNOWN	

<b>WITNESS</b>	NAME: LAST, FIRST, MIDDLE				DATE OF BIRTH		AGE	GENDER	
	ADDRESS: STREET, CITY, STATE, ZIP				CONTACT PHONE - INCLUDE AREA CODE				

<b>WITNESS</b>	NAME: LAST, FIRST, MIDDLE				DATE OF BIRTH		AGE	GENDER	
	ADDRESS: STREET, CITY, STATE, ZIP				CONTACT PHONE - INCLUDE AREA CODE				

<b>WITNESS</b>	NAME: LAST, FIRST, MIDDLE				DATE OF BIRTH		AGE	GENDER	
	ADDRESS: STREET, CITY, STATE, ZIP				CONTACT PHONE - INCLUDE AREA CODE				

LOCAL REPORT NUMBER <b>2020051</b>	REPORTING AGENCY <b>RICHFIELD POLICE</b>	DATE OF CRASH <b>MOS 10 9 Y 2020</b>
IN COUNTY OF <b>Summit</b>	CRASH LOCATION <b>77N @ 145.8</b>	

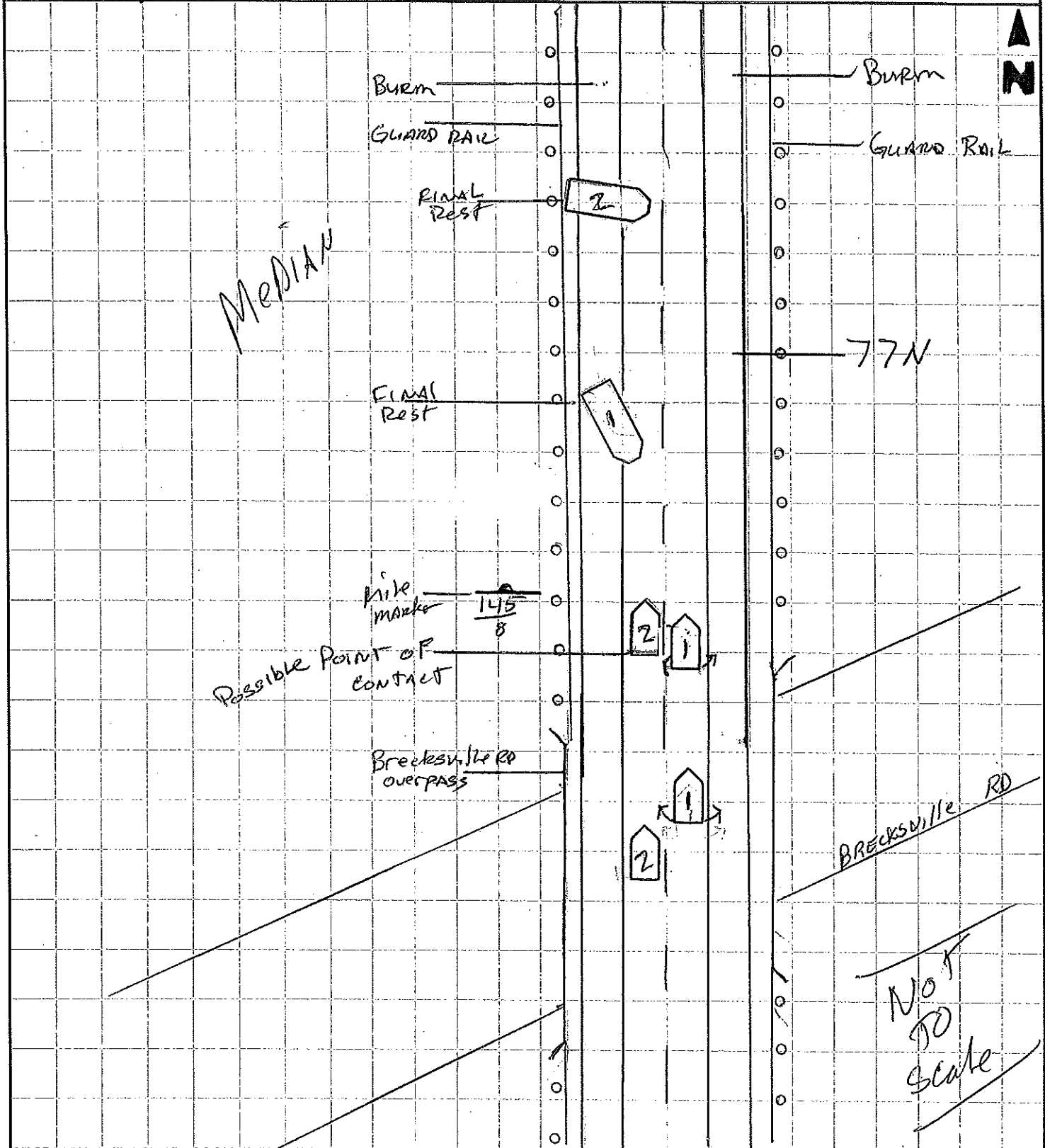

OFFICER'S SIGNATURE <b>X [Signature]</b>	BADGE NUMBER <b>718</b>
---	----------------------------



LOCAL REPORT NUMBER 2020 051	REPORTING AGENCY RIGHTFIELD POLICE	DATE OF CRASH NOV 09 20
---------------------------------	---------------------------------------	----------------------------

FOR LOCAL USE ONLY – DO NOT SUBMIT TO THE STATE EXCEPT FOR FATAL CRASHES

I, MICHAEL T. STIEBER HEREBY MAKE THIS VOLUNTARY STATEMENT TO  
PRINTED

P.O. Runneth AT 77 NB 146  
OFFICER'S NAME LOCATION

I WAS TRAVELING ON 77 NB, IN LEFT LANE, SLOWED DOWN TO AROUND 55 TO APPROACH Icy BRIDGE DUE TO FRESH SNOW/FREEZE IN MAY. VEHICLE IN THE RIGHT LANE BEGAN TO SPIN OUT OF CONTROL UPON HITTING BUMP AT BEGINNING OF BRIDGE, I SLOWED DOWN MORE TO ALLOW THEM ROOM TO REGAN CONTROL, THEIR VEHICLE SPUN OUT MORE AGGRESSIVELY, EVENTUALLY SLAMMING INTO THE SIDE OF MY VEHICLE, SENDING BOTH OUR VEHICLES SPINNING INTO GUARDRAILS. I FEEL LIKE OUR VEHICLES MAY HAVE BEEN CONNECTED AT SOME POINT, SLAMMING/SPINNING TOGETHER. I EVENTUALLY CAME TO A STOP AT THE GUARDRAIL.

DEFINATELY EXPERIENCED WHIPLASH, BACK PAIN PRESENT AFTER HITTING.

SPEED 55 MPH  
 DRIVER HAD SEAT BELTS ON.

3557 Knowlwood Ln. Akron OH 44333

ADDRESS OF WITNESS PHONE  
 330-212-9560

SIGNATURE OF WITNESS [Signature] OFFICER'S SIGNATURE  
 X [Signature] X P.O. Runneth 740





LOCAL REPORT NUMBER 2020 051	REPORTING AGENCY RICHFIELD POLICE	DATE OF CRASH MAR 10 2020
---------------------------------	--------------------------------------	------------------------------

**FOR LOCAL USE ONLY – DO NOT SUBMIT TO THE STATE EXCEPT FOR FATAL CRASHES**

I, Nia Spaulding PRINTED HEREBY MAKE THIS VOLUNTARY STATEMENT TO  
PLD Rivetta 740 OFFICER'S NAME AT 77 NB AT MP 146 LOCATION  
 We started to slide on the bridge with ice and hit the railing.  
 DRIVER STATES 60 MPH SPEED.  
 ALL PASSENGERS WERE WEARING SEATBELTS.

ADDRESS OF WITNESS 712 18th St NE Canton, OH 44714	PHONE 330-417-7790
SIGNATURE OF WITNESS X <u>Nia Spaulding</u>	OFFICER'S SIGNATURE X <u>PLD Rivetta 740</u>