



# TRAFFIC CRASH REPORT

\*DENOTES MANDATORY FIELD FOR SUPPLEMENT REPORT

LOCAL REPORT NUMBER\*

2023003

PHOTOS TAKEN     OH-2     OH-3  
 SECONDARY CRASH     OH-1P     OTHER  
 PRIVATE PROPERTY

LOCAL INFORMATION 271 N  
 REPORTING AGENCY NAME\* RICHFIELD POLICE  
 NCIC\* 07726

HIT/SKIP  
 1 - SOLVED  
 2 - UNSOLVED  
 NUMBER OF UNITS 02  
 UNIT IN ERROR  
 99 - ANIMAL  
 99 - UNKNOWN

COUNTY\* 77    LOCALITY\* 3  
 1 - CITY  
 2 - VILLAGE  
 3 - TOWNSHIP  
 LOCATION: CITY, VILLAGE, TOWNSHIP\* RICHFIELD

CRASH DATE / TIME\* 12/17/2022 19:00  
 CRASH SEVERITY 5  
 1 - FATAL  
 2 - SERIOUS INJURY SUSPECTED  
 3 - MINOR INJURY SUSPECTED  
 4 - INJURY POSSIBLE  
 5 - PROPERTY DAMAGE ONLY

ROUTE TYPE IR    ROUTE NUMBER 271    PREFIX N - NORTH  
 S - SOUTH  
 E - EAST  
 W - WEST  
 LOCATION ROAD NAME I-271    ROAD TYPE HW

LATITUDE DECIMAL DEGREE 41.237079

ROUTE TYPE    ROUTE NUMBER    PREFIX N - NORTH  
 S - SOUTH  
 E - EAST  
 W - WEST  
 REFERENCE ROAD NAME (ROAD, MILEPOST, HOUSE #) 12    ROAD TYPE MP

LONGITUDE DECIMAL DEGREE 81.595641

REFERENCE POINT  
 1 - INTERSECTION  
 2 - MILE POST  
 3 - HOUSE #    2  
 DIRECTION FROM REFERENCE  
 N - NORTH  
 S - SOUTH  
 E - EAST  
 W - WEST    S  
 ROUTE TYPE  
 IR - INTERSTATE ROUTE(TP)  
 US - FEDERAL US ROUTE  
 SR - STATE ROUTE  
 CR - NUMBERED COUNTY ROUTE  
 TR - NUMBERED TOWNSHIP ROUTE  
 ROAD TYPE  
 AL - ALLEY    HW - HIGHWAY    RD - ROAD  
 AV - AVENUE    LA - LANE    SQ - SQUARE  
 BL - BOULEVARD    MP - MILEPOST    ST - STREET  
 CR - CIRCLE    OV - OVAL    TE - TERRACE  
 CT - COURT    PK - PARKWAY    TL - TRAIL  
 DR - DRIVE    PI - PIKE    WA - WAY  
 HE - HEIGHTS    PL - PLACE

INTERSECTION RELATED  
 WITHIN INTERSECTION OR ON APPROACH  
 WITHIN INTERCHANGE AREA    NUMBER OF APPROACHES  
 ROADWAY  
 ROADWAY DIVIDED

LOCATION OF FIRST HARMFUL EVENT  
 1 - ON ROADWAY  
 2 - ON SHOULDER  
 3 - IN MEDIAN  
 4 - ON ROADSIDE  
 5 - ON GORE  
 6 - OUTSIDE TRAFFIC WAY  
 7 - ON RAMP  
 8 - OFF RAMP    1  
 9 - CROSSOVER  
 10 - DRIVEWAY/ALLEY ACCESS  
 11 - RAILWAY GRADE CROSSING  
 12 - SHARED USE PATHS OR TRAILS  
 13 - BIKE LANE  
 14 - TOLL BOOTH  
 99 - OTHER / UNKNOWN

MANNER OF CRASH COLLISION/IMPACT  
 1 - NOT COLLISION BETWEEN TWO MOTOR VEHICLES IN TRANSPORT  
 2 - REAR-END  
 3 - HEAD-ON    7  
 4 - REAR-TO-REAR  
 5 - BACKING  
 6 - ANGLE  
 7 - SIDESWIPE, SAME DIRECTION  
 8 - SIDESWIPE, OPPOSITE DIRECTION  
 9 - OTHER / UNKNOWN

DIRECTION OF TRAVEL N - NORTH  
 S - SOUTH  
 E - EAST  
 W - WEST    N  
 MEDIAN TYPE  
 1 - DIVIDED FLUSH MEDIAN (<4 FEET)  
 2 - DIVIDED FLUSH MEDIAN (≥4 FEET)  
 3 - DIVIDED, DEPRESSED MEDIAN  
 4 - DIVIDED, RAISED MEDIAN (ANY TYPE)  
 9 - OTHER/UNKNOWN    4

WORK ZONE RELATED  
 WORKERS PRESENT  
 LAW ENFORCEMENT PRESENT  
 ACTIVE SCHOOL ZONE

WORK ZONE TYPE  
 1 - LANE CLOSURE  
 2 - LANE SHIFT/CROSSOVER  
 3 - WORK ON SHOULDER OR MEDIAN  
 4 - INTERMITTENT OR MOVING WORK  
 5 - OTHER

LOCATION OF CRASH IN WORK ZONE  
 1 - BEFORE THE 1ST WORK ZONE WARNING SIGN  
 2 - ADVANCE WARNING AREA  
 3 - TRANSITION AREA  
 4 - ACTIVITY AREA  
 5 - TERMINATION AREA

CONTOUR 4  
 1 - STRAIGHT LEVEL  
 2 - STRAIGHT GRADE  
 3 - CURVE LEVEL  
 4 - CURVE GRADE  
 9 - OTHER/UNKNOWN

CONDITIONS 1  
 1 - DRY  
 2 - WET  
 3 - SNOW  
 4 - ICE  
 5 - SAND, MUD, DIRT, OIL, GRAVEL  
 6 - WATER (STANDING, MOVING)  
 7 - SLUSH  
 9 - OTHER/UNKNOWN

SURFACE 2  
 1 - CONCRETE  
 2 - BLACKTOP, BITUMINOUS, ASPHALT  
 3 - BRICK/BLOCK  
 4 - SLAG, GRAVEL, STONE  
 5 - DIRT  
 9 - OTHER/UNKNOWN

LIGHT CONDITION  
 1 - DAYLIGHT  
 2 - DAWN/DUSK  
 3 - DARK - LIGHTED ROADWAY  
 4 - DARK - ROADWAY NOT LIGHTED  
 5 - DARK - UNKNOWN ROADWAY LIGHTING  
 9 - OTHER / UNKNOWN    4

WEATHER  
 1 - CLEAR    6 - SNOW  
 2 - CLOUDY    7 - SEVERE CROSSWINDS  
 3 - FOG, SMOG, SMOKE    8 - BLOWING SAND, SOIL, DIRT, SNOW  
 4 - RAIN    9 - FREEZING RAIN OR FREEZING DRIZZLE  
 5 - SLEET, HAIL    99 - OTHER / UNKNOWN

Both Units were traveling North on IR271. Driver of Unit #01 stated she does not know what happened. Driver of Unit #02 stated that Unit #01 was partially in his lane and made contact with his vehicle. Both Units Drove off the highway to another location and after talking with a Peninsula Officer they were transfered back to Richfield PD. Due to another pending emergency call no photos or written statements were obtained. Officers were not able to determine fault due to conflicting statements.

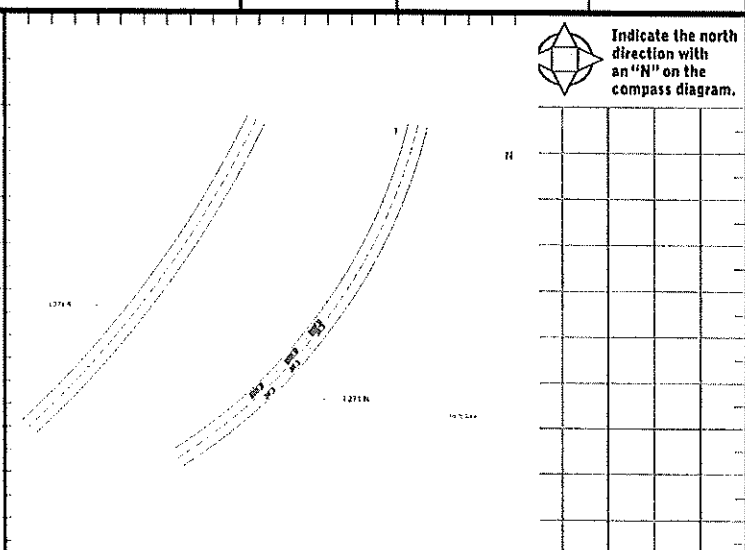

CRASH REPORTED DATE / TIME 12/17/2022 19:00		DISPATCH DATE / TIME 12/17/2022 19:00		ARRIVAL DATE / TIME 12/17/2022 19:18		SCENE CLEARED DATE / TIME 12/17/2022 19:20		REPORT TAKEN BY <input checked="" type="checkbox"/> POLICE AGENCY <input type="checkbox"/> MOTORIST	
TOTAL TIME ROADWAY CLOSED 0	OTHER INVESTIGATION TIME 60	TOTAL MINUTES 60	OFFICER'S NAME* DOUGLAS MCARTOR		CHECKED BY OFFICER'S NAME* MICHAEL TESTA		SUPPLEMENT (CORRECTION OR ADDITION) 15 (48 EXISTING REPORT MAY 12, 2015)		
			OFFICER'S BADGE NUMBER* 721		CHECKED BY OFFICER'S BADGE NUMBER* 717				

**OWNER**

UNIT # **01** OWNER NAME: LAST, FIRST, MIDDLE (SAME AS DRIVER) **SMITH DAVID WILLIAM** OWNER PHONE: INCLUDE AREA CODE (SAME AS DRIVER) **330-685-6011**

OWNER ADDRESS: STREET, CITY, STATE, ZIP (SAME AS DRIVER) **9572 BRIDGEVIEW DR DEERFIELD OH 44411**

COMMERCIAL CARRIER: NAME, ADDRESS, CITY, STATE, ZIP \_\_\_\_\_ COMMERCIAL CARRIER PHONE: INCLUDE AREA CODE \_\_\_\_\_

**DAMAGE**

DAMAGE SCALE

**3** 1 - NONE 3 - FUNCTIONAL DAMAGE  
 2 - MINOR DAMAGE 4 - DISABLING DAMAGE  
 9 - UNKNOWN

**VEHICLE**

LP STATE **OH** LICENSE PLATE # **HCY5852** VEHICLE IDENTIFICATION # **3LN6L2GKXDR817367** VEHICLE YEAR **2013** VEHICLE MAKE **LINC**

INSURANCE VERIFIED INSURANCE COMPANY **ALLSTATE** INSURANCE POLICY # **992215062** COLOR **BLU /** VEHICLE MODEL **MKZ**

COMMERCIAL  GOVERNMENT  IN EMERGENCY RESPONSE US DOT # \_\_\_\_\_ TOWED BY: COMPANY NAME \_\_\_\_\_

INTERLOCK DEVICE EQUIPPED  HIT/SKIP UNIT #OCCUPANTS **01** VEHICLE WEIGHT GVWR/GCWR 1 - <10K LBS. 2 - 10,001 - 26K LBS. 3 - >26K LBS. HAZARDOUS MATERIAL  MATERIAL RELEASED  PLACARD CLASS # PLACARD ID # \_\_\_\_\_

**DAMAGED AREA(S)**  
 INDICATE ALL THAT APPLY  
**10 11 12**

**UNIT TYPE**

**1**

1 - PASSENGER CAR 7 - MOTORCYCLE 2-WHEELED 12 - GOLF CART 18 - LIMO (LIVERY VEHICLE) 23 - PEDESTRIAN / SKATER  
 2 - PASSENGER VAN (MINIVAN) 8 - MOTORCYCLE 3-WHEELED 13 - SNOWMOBILE 19 - BUS (16+ PASSENGERS) 24 - WHEELCHAIR (ANY TYPE)  
 3 - SPORT UTILITY VEHICLE 9 - AUTOCYCLE 14 - SINGLE UNIT TRUCK 20 - OTHER VEHICLE 25 - OTHER NON-MOTORIST  
 4 - PICK UP 10 - MOPED OR MOTORIZED BICYCLE 15 - SEMI-TRACTOR 21 - HEAVY EQUIPMENT 26 - BICYCLE  
 5 - CARGO VAN 11 - ALL TERRAIN VEHICLE (ATV/UTV) 16 - FARM EQUIPMENT 22 - ANIMAL WITH RIDER OR ANIMAL-DRAWN VEHICLE 27 - TRAIN  
 6 - VAN (19-15 SEATS) 17 - MOTORHOME 99 - UNKNOWN OR HIT/SKIP

# OF TRAILING UNITS \_\_\_\_\_

**DAMAGED AREA(S)**  
 INDICATE ALL THAT APPLY  
**10 11 12**

**SPECIAL FUNCTION**

**1**

1 - NONE 6 - BUS - CHARTER/TOUR 11 - FIRE 16 - FARM 21 - MAIL CARRIER  
 2 - TAXI 7 - BUS - INTERCITY 12 - MILITARY 17 - MOWING 99 - OTHER / UNKNOWN  
 3 - ELECTRONIC RIDE SHARING 8 - BUS - SHUTTLE 13 - POLICE 18 - SNOW REMOVAL  
 4 - SCHOOL TRANSPORT 9 - BUS - OTHER 14 - PUBLIC UTILITY 19 - TOWING  
 5 - BUS - TRANSIT/COMMUTER 10 - AMBULANCE 15 - CONSTRUCTION EQUIPMENT 20 - SAFETY SERVICE PATROL

**DAMAGED AREA(S)**  
 INDICATE ALL THAT APPLY  
**10 11 12**

**CARGO BODY TYPE**

**1**

1 - NO CARGO BODY TYPE / NOT APPLICABLE 3 - VEHICLE TOWING ANOTHER MOTORVEHICLE 5 - INTERMODAL CONTAINER CHASSIS 8 - POLE 12 - CONCRETE MIXER  
 2 - BUS 4 - LOGGING 6 - CARGO VAN/ENCLOSED BOX 9 - CARGO TANK 13 - AUTO TRANSPORTER  
 7 - GRAIN/CHIPS/GRAVEL 10 - FLAT BED 11 - DUMP 14 - GARBAGE/REFUSE 99 - OTHER / UNKNOWN

**DAMAGED AREA(S)**  
 INDICATE ALL THAT APPLY  
**10 11 12**

**VEHICLE DEFECTS**

**1**

1 - TURN SIGNALS 4 - BRAKES 7 - WORN OR SLICK TIRES 9 - MOTOR TROUBLE 99 - OTHER / UNKNOWN  
 2 - HEAD LAMPS 5 - STEERING 8 - TRAILER EQUIPMENT DEFECTIVE 10 - DISABLED FROM PRIOR ACCIDENT  
 3 - TAIL LAMPS 6 - TIRE BLOWOUT

**DAMAGED AREA(S)**  
 INDICATE ALL THAT APPLY  
**10 11 12**

**NON-MOTORIST LOCATION AT IMPACT**

**1**

1 - INTERSECTION - MARKED CROSSWALK 3 - INTERSECTION - OTHER 6 - BICYCLE LANE 9 - MEDIUM CROSSING ISLAND 12 - FIRST RESPONDER AT INCIDENT SCENE  
 2 - INTERSECTION - UNMARKED CROSSWALK 4 - MIDDLEBLOCK - MARKED CROSSWALK 7 - SHOULDER / ROADSIDE 10 - DRIVEWAY ACCESS 99 - OTHER / UNKNOWN  
 5 - TRAVEL LANE - OTHER LOCATION 8 - SIDEWALK 11 - SHARED USE PATHS OR TRAILS

**DAMAGED AREA(S)**  
 INDICATE ALL THAT APPLY  
**10 11 12**

**ACTION**

**9**

1 - NON-CONTACT 1 - STRAIGHT AHEAD 7 - MAKING U-TURN 13 - NEGOTIATING A CURVE 18 - APPROACHING OR LEAVING VEHICLE  
 2 - NON-COLLISION 2 - BACKING 8 - ENTERING TRAFFIC LANE 14 - ENTERING OR CROSSING SPECIFIED LOCATION 19 - STANDING  
 3 - STRIKING 3 - CHANGING LANES 9 - LEAVING TRAFFIC LANE 15 - WALKING, RUNNING, JOGGING, PLAYING 20 - OTHER NON-MOTORIST  
 4 - STRUCK PRE-CRASH ACTIONS 4 - OVERTAKING/PASSING 10 - PARKED 16 - WORKING 21 - STANDING OUTSIDE DISABLED VEHICLE  
 5 - BOTH STRIKING & STRUCK 5 - MAKING RIGHT TURN 11 - SLOWING OR STOPPED IN TRAFFIC 17 - PUSHING VEHICLE 99 - OTHER / UNKNOWN  
 9 - OTHER / UNKNOWN 6 - MAKING LEFT TURN 12 - DRIVERLESS 99 - OTHER / UNKNOWN

**DAMAGED AREA(S)**  
 INDICATE ALL THAT APPLY  
**10 11 12**

**CONTRIBUTING CIRCUMSTANCES**

**99**

1 - NONE 7 - LEFT OF CENTER 13 - IMPROPER START FROM A PARKED POSITION 17 - VISION OBSTRUCTION 21 - LYING IN ROADWAY  
 2 - FAILURE TO YIELD 8 - FOLLOWING TOO CLOSE / ACDA 14 - OPERATING DEFECTIVE EQUIPMENT 18 - NOT DISCERNIBLE 22 - NOT DISCERNIBLE  
 3 - RAN RED LIGHT 9 - IMPROPER LANE CHANGE 15 - STOPPED OR PARKED ILLEGALLY 19 - LOAD SHIFTING/FALLING/SPILLING 23 - OPENING DOOR INTO ROADWAY  
 4 - RAN STOP SIGN 10 - IMPROPER PASSING 16 - SWERVING TO AVOID 99 - OTHER IMPROPER ACTION  
 5 - UNSAFE SPEED 11 - DROVE OFF ROAD 17 - WRONG WAY 20 - IMPROPER CROSSING  
 6 - IMPROPER TURN 12 - IMPROPER BACKING

**DAMAGED AREA(S)**  
 INDICATE ALL THAT APPLY  
**10 11 12**

**SEQUENCE OF EVENTS**

**20**

1 - OVERTURN/ROLLOVER 6 - EQUIPMENT FAILURE 11 - CROSS CENTERLINE - OPPOSITE DIRECTION OF TRAVEL 16 - RAILWAY VEHICLE 22 - WORK ZONE MAINTENANCE EQUIPMENT  
 2 - FIRE/EXPLOSION 7 - SEPARATION OF UNITS 12 - DOWNHILL RUNAWAY 17 - ANIMAL - FARM 23 - STRUCK BY FALLING, SHIFTING CARGO OR ANYTHING SET IN MOTION BY A MOTORVEHICLE  
 3 - IMMERSION 8 - RAN OFF ROAD RIGHT 13 - OTHER NON-COLLISION 18 - ANIMAL - DEER 24 - OTHER MOVABLE OBJECT  
 4 - JACKKNIFE 9 - RAN OFF ROAD LEFT 14 - PEDESTRIAN 19 - ANIMAL - OTHER 20 - MOTORVEHICLE IN TRANSPORT  
 5 - CARGO/EQUIPMENT LOSS OR SHIFT 10 - CROSS MEDIAN 15 - PEDALCYCLE 21 - PARKED MOTORVEHICLE

**DAMAGED AREA(S)**  
 INDICATE ALL THAT APPLY  
**10 11 12**

**NON-COLLISION**

**1**

11 - CROSS CENTERLINE - OPPOSITE DIRECTION OF TRAVEL 16 - RAILWAY VEHICLE 22 - WORK ZONE MAINTENANCE EQUIPMENT  
 12 - DOWNHILL RUNAWAY 17 - ANIMAL - FARM 23 - STRUCK BY FALLING, SHIFTING CARGO OR ANYTHING SET IN MOTION BY A MOTORVEHICLE  
 13 - OTHER NON-COLLISION 18 - ANIMAL - DEER 24 - OTHER MOVABLE OBJECT  
 14 - PEDESTRIAN 19 - ANIMAL - OTHER 20 - MOTORVEHICLE IN TRANSPORT  
 15 - PEDALCYCLE 21 - PARKED MOTORVEHICLE

**DAMAGED AREA(S)**  
 INDICATE ALL THAT APPLY  
**10 11 12**

**COLLISION WITH FIXED OBJECT - STRUCK**

**1**

25 - IMPACT ATTENUATOR / CRASH CUSHION 31 - GUARDRAIL END 37 - TRAFFIC SIGN POST 43 - CURB 50 - WORK ZONE MAINTENANCE EQUIPMENT  
 26 - BRIDGE OVERHEAD STRUCTURE 32 - PORTABLE BARRIER 38 - OVERHEAD SIGN POST 44 - DITCH 51 - WALL  
 27 - BRIDGE PIER OR ABUTMENT 33 - MEDIUM CABLE BARRIER 39 - LIGHT / LUMINARIES SUPPORT 45 - EMBANKMENT 52 - BUILDING  
 28 - BRIDGE PARAPET 34 - MEDIUM GUARDRAIL BARRIER 40 - UTILITY POLE 46 - FENCE 53 - TUNNEL  
 29 - BRIDGE RAIL 35 - MEDIUM CONCRETE BARRIER 41 - OTHER POST, POLE OR SUPPORT 47 - MAILBOX 54 - OTHER FIXED OBJECT  
 30 - GUARDRAIL FACE 36 - MEDIUM OTHER BARRIER 42 - CULVERT 48 - TREE 99 - OTHER / UNKNOWN  
 49 - FIRE HYDRANT

**1** FIRST HARMFUL EVENT **1** MOST HARMFUL EVENT

**DAMAGED AREA(S)**  
 INDICATE ALL THAT APPLY  
**10 11 12**

**TRAFFIC**

TRAFFICWAY FLOW

**1** 1 - ONE-WAY 2 - TWO-WAY

# OF THROUGH LANES ON ROAD **02**

TRAFFIC CONTROL

**6** 1 - ROUNDABOUT 4 - STOP SIGN 2 - SIGNAL 5 - YIELD SIGN 3 - FLASHER 6 - NO CONTROL

# OF THROUGH LANES ON ROAD **02**

RAIL GRADE CROSSING

**1** 1 - NOT INVOLVED 2 - INVOLVED-ACTIVE CROSSING 3 - INVOLVED-PASSIVE CROSSING

**UNIT / NON-MOTORIST DIRECTION**

FROM **2** TO **1**

1 - NORTH 5 - NORTHEAST  
 2 - SOUTH 6 - NORTHWEST  
 3 - EAST 7 - SOUTHEAST  
 4 - WEST 8 - SOUTHWEST  
 9 - OTHER / UNKNOWN

**UNIT SPEED**

**75**

**POSTED SPEED**

**70**

**DETECTED SPEED**

**1** 1 - STATED/ESTIMATED SPEED 2 - CALCULATED / EDR 3 - UNDETERMINED

**OWNER**

UNIT # 02 OWNER NAME: LAST, FIRST, MIDDLE (SAME AS DRIVER) DRAZIL BRANNDON ERIK OWNER PHONE: INCLUDE AREA CODE (SAME AS DRIVER) 216-410-4039

OWNER ADDRESS: STREET, CITY, STATE, ZIP (SAME AS DRIVER) 9125 CAMBRIDGE DR NORTHFIELD OH 44067

COMMERCIAL CARRIER: NAME, ADDRESS, CITY, STATE, ZIP \_\_\_\_\_ COMMERCIAL CARRIER PHONE: INCLUDE AREA CODE \_\_\_\_\_

**VEHICLE**

LP STATE OH LICENSE PLATE # PLQ6104 VEHICLE IDENTIFICATION # 1FTPW14V08FB24903 VEHICLE YEAR 2008 VEHICLE MAKE FORD

INSURANCE VERIFIED INSURANCE COMPANY PROGRESSIVE INSURANCE POLICY # 9630844929 COLOR RED / VEHICLE MODEL F15

COMMERCIAL  GOVERNMENT  IN EMERGENCY RESPONSE TYPE OF USE US DOT # TOWED BY: COMPANY NAME

INTERLOCK DEVICE EQUIPPED  HIT/SKIP UNIT #OCCUPANTS 01 VEHICLE WEIGHT GVWR/GCWR 1 - <10K LBS. 2 - 10,001 - 26K LBS. 3 - >26K LBS. HAZARDOUS MATERIAL  MATERIAL RELEASED  PLACARD CLASS # PLACARD ID #

UNIT TYPE 1 1 - PASSENGER CAR 7 - MOTORCYCLE 2-WHEELED 12 - GOLF CART 18 - LIMO (LIVERY VEHICLE) 23 - PEDESTRIAN / SKATER  
 2 - PASSENGER VAN (MINIVAN) 8 - MOTORCYCLE 3-WHEELED 13 - SNOWMOBILE 19 - BUS (16+ PASSENGERS) 24 - WHEELCHAIR (ANY TYPE)  
 3 - SPORT UTILITY VEHICLE 9 - AUTOCYCLE 14 - SINGLE UNIT TRUCK 20 - OTHER VEHICLE 25 - OTHER NON-MOTORIST  
 4 - PICK UP 10 - MOPED OR MOTORIZED BICYCLE 15 - SEMI-TRACTOR 21 - HEAVY EQUIPMENT 26 - BICYCLE  
 5 - CARGO VAN 11 - ALL TERRAIN VEHICLE (ATV / UTV) 16 - FARM EQUIPMENT 22 - ANIMAL WITH RIDER OR ANIMAL-DRAWN VEHICLE 27 - TRAIN  
 6 - VAN (9-15 SEATS) 17 - MOTORHOME 99 - UNKNOWN OR HITSKIP

# OF TRAILING UNITS \_\_\_\_\_

WAS VEHICLE OPERATING IN AUTONOMOUS MODE WHEN CRASH OCCURRED? 2 1 - YES 2 - NO 9 - OTHER / UNKNOWN AUTONOMOUS MODE LEVEL 0 0 - NO AUTOMATION 1 - DRIVER ASSISTANCE 2 - PARTIAL AUTOMATION 3 - CONDITIONAL AUTOMATION 4 - HIGH AUTOMATION 5 - FULL AUTOMATION 9 - UNKNOWN

SPECIAL FUNCTION 1 1 - NONE 6 - BUS - CHARTER/TOUR 11 - FIRE 16 - FARM 21 - MAIL CARRIER  
 2 - TAXI 7 - BUS - INTERCITY 12 - MILITARY 17 - MOWING 99 - OTHER / UNKNOWN  
 3 - ELECTRONIC RIDE SHARING 8 - BUS - SHUTTLE 13 - POLICE 18 - SNOW REMOVAL  
 4 - SCHOOL TRANSPORT 9 - BUS - OTHER 14 - PUBLIC UTILITY 19 - TOWING  
 5 - BUS - TRANSIT/COMMUTER 10 - AMBULANCE 15 - CONSTRUCTION EQUIPMENT 20 - SAFETY SERVICE PATROL

CARGO BODY TYPE 1 1 - NO CARGO BODY TYPE / NOT APPLICABLE 3 - VEHICLE TOWING ANOTHER MOTOR VEHICLE 5 - INTERMODAL CONTAINER CHASSIS 8 - POLE 12 - CONCRETE MIXER  
 2 - BUS 4 - LOGGING 6 - CARGO VAN/ENCLOSED BOX 9 - CARGO TANK 13 - AUTO TRANSPORTER  
 7 - GRAIN/CHIPS/GRAVEL 10 - FLAT BED 14 - GARBAGE/REFUSE 99 - OTHER / UNKNOWN

VEHICLE DEFECTS 1 1 - TURN SIGNALS 4 - BRAKES 7 - WORN OR SLICK TIRES 9 - MOTOR TROUBLE 99 - OTHER / UNKNOWN  
 2 - HEAD LAMPS 5 - STEERING 8 - TRAILER EQUIPMENT DEFECTIVE 10 - DISABLED FROM PRIOR ACCIDENT  
 3 - TAIL LAMPS 6 - TIRE BLOWOUT

NON-MOTORIST LOCATION AT IMPACT 1 1 - INTERSECTION - MARKED CROSSWALK 3 - INTERSECTION - OTHER 6 - BICYCLE LANE 9 - MEDIAN/CROSSING ISLAND 12 - FIRST RESPONDER AT INCIDENT SCENE  
 2 - INTERSECTION - UNMARKED CROSSWALK 4 - MIDBLOCK - MARKED CROSSWALK 7 - SHOULDER / ROADSIDE 10 - DRIVEWAY ACCESS 11 - SHARED USE PATHS OR TRAILS 15 - OTHER / UNKNOWN  
 5 - TRAVEL LANE - OTHER LOCATION

ACTION 9 1 - NON-CONTACT 1 - STRAIGHT AHEAD 7 - MAKING U-TURN 13 - NEGOTIATING A CURVE 18 - APPROACHING OR LEAVING VEHICLE  
 2 - NON-COLLISION 2 - BACKING 8 - ENTERING TRAFFIC LANE 14 - ENTERING OR CROSSING SPECIFIED LOCATION 19 - STANDING  
 3 - STRIKING 99 3 - CHANGING LANES 9 - LEAVING TRAFFIC LANE 15 - WALKING, RUNNING, JOGGING, PLAYING 20 - OTHER NON-MOTORIST  
 4 - STRUCK PRE-CRASH ACTIONS 4 - OVERTAKING/PASSING 10 - PARKED 16 - WORKING 21 - STANDING OUTSIDE DISABLED VEHICLE  
 5 - BOTH STRIKING & STRUCK 5 - MAKING RIGHT TURN 11 - SLOWING OR STOPPED IN TRAFFIC 17 - PUSHING VEHICLE 99 - OTHER / UNKNOWN  
 6 - MAKING LEFT TURN 12 - DRIVERLESS 17 - PUSHING VEHICLE 99 - OTHER / UNKNOWN  
 9 - OTHER / UNKNOWN

CONTRIBUTING CIRCUMSTANCES 99 1 - NONE 7 - LEFT OF CENTER 13 - IMPROPER START FROM A PARKED POSITION 17 - VISION OBSTRUCTION 21 - LYING IN ROADWAY  
 2 - FAILURE TO YIELD 8 - FOLLOWING TOO CLOSE / ACGA 14 - OPERATING DEFECTIVE EQUIPMENT 18 - OPERATING DEFECTIVE EQUIPMENT 22 - NOT DISCERNIBLE  
 3 - RAN RED LIGHT 9 - IMPROPER LANE CHANGE 15 - STOPPED OR PARKED ILLEGALLY 19 - LOAD SHIFTING/FALLING/SPILLING 23 - OPENING DOOR INTO ROADWAY  
 4 - RAN STOP SIGN 10 - IMPROPER PASSING 16 - WRONG WAY 20 - IMPROPER CROSSING 99 - OTHER IMPROPER ACTION  
 5 - UNSAFE SPEED 11 - DROVE OFF ROAD 17 - SWERVING TO AVOID 21 - IMPROPER CROSSING  
 6 - IMPROPER TURN 12 - IMPROPER BACKING 18 - WRONG WAY

**EVENT(S)**

SEQUENCE OF EVENTS 20 1 - OVERTURN/ROLLOVER 6 - EQUIPMENT FAILURE 11 - CROSS CENTERLINE - OPPOSITE DIRECTION OF TRAVEL 16 - RAILWAY VEHICLE 22 - WORK ZONE MAINTENANCE EQUIPMENT  
 2 - FIRE/EXPLOSION 7 - SEPARATION OF UNITS 12 - DOWNHILL RUNAWAY 17 - ANIMAL - FARM 23 - STRUCK BY FALLING, SHIFTING CARGO OR ANYTHING SET IN MOTION BY A MOTOR VEHICLE  
 3 - IMMERSION 8 - RAN OFF ROAD RIGHT 13 - OTHER NON-COLLISION 18 - ANIMAL - DEER 24 - OTHER MOVABLE OBJECT  
 4 - JACKKNIFE 9 - RAN OFF ROAD LEFT 14 - PEDESTRIAN 19 - ANIMAL - OTHER 20 - MOTOR VEHICLE IN TRANSPORT  
 5 - CARGO / EQUIPMENT LOSS OR SHIFT 10 - CROSS MEDIAN 15 - PEDALCYCLE 21 - PARKED MOTOR VEHICLE

**COLLISION WITH FIXED OBJECT - STRUCK**

1 - IMPACT ATTENUATOR / CRASH CUSHION 31 - GUARDRAIL END 37 - TRAFFIC SIGN POST 43 - CURB 50 - WORK ZONE MAINTENANCE EQUIPMENT  
 2 - BRIDGE OVERHEAD STRUCTURE 32 - PORTABLE BARRIER 38 - OVERHEAD SIGN POST 44 - DITCH 51 - WALL  
 3 - BRIDGE PIER OR ABUTMENT 33 - MEDIAN CABLE BARRIER 39 - LIGHT / LUMINARIES SUPPORT 45 - EMBANKMENT 52 - BUILDING  
 4 - BRIDGE PARAPET 34 - MEDIAN GUARDRAIL BARRIER 40 - UTILITY POLE 46 - FENCE 53 - TUNNEL  
 5 - BRIDGE RAIL 35 - MEDIAN CONCRETE BARRIER 41 - OTHER POST, POLE OR SUPPORT 47 - MAILBOX 54 - OTHER FIXED OBJECT  
 6 - GUARDRAIL FACE 36 - MEDIAN OTHER BARRIER 42 - CULVERT 48 - TREE 55 - OTHER / UNKNOWN  
 49 - FIRE HYDRANT

FIRST HARMFUL EVENT 1 MOST HARMFUL EVENT 1

LOCAL REPORT NUMBER  
2023003

**DAMAGE**

DAMAGE SCALE 3 1 - NONE 3 - FUNCTIONAL DAMAGE  
 2 - MINOR DAMAGE 4 - DISABLING DAMAGE  
 9 - UNKNOWN

**DAMAGED AREA(S)**  
 INDICATE ALL THAT APPLY  
1 2 3

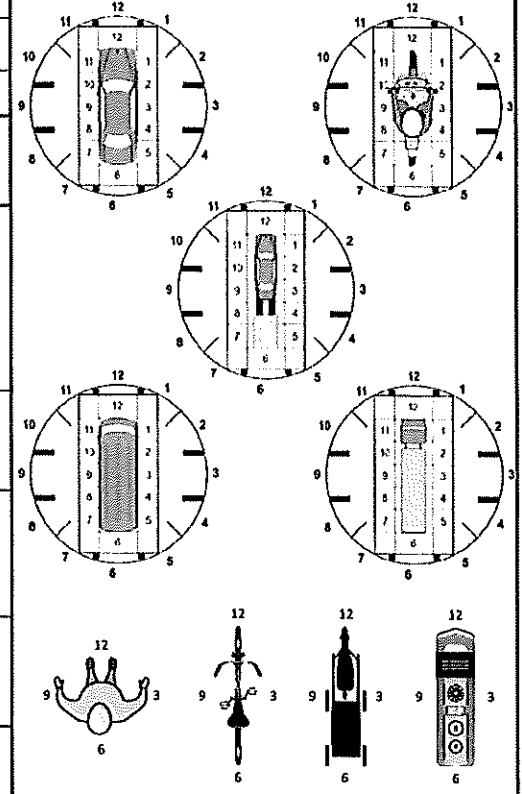

NO DAMAGE ( 0 )  UNDERCARRIAGE ( 14 )  
 TOP ( 13 )  ALL AREAS ( 15 )  
 UNIT NOT AT SCENE ( 16 )

**INITIAL POINT OF CONTACT**

2 0 - NO DAMAGE 14 - UNDERCARRIAGE  
 1-12 - REFER TO UNIT DIAGRAM 15 - VEHICLE NOT AT SCENE  
 99 - UNKNOWN  
 13 - TOP

**TRAFFIC**

TRAFFICWAY FLOW 1 1 - ONE-WAY 2 - TWO-WAY

TRAFFIC CONTROL 6 1 - ROUNDABOUT 4 - STOP SIGN  
 2 - SIGNAL 5 - YIELD SIGN  
 3 - FLASHER 6 - NO CONTROL

# OF THROUGH LANES ON ROAD 02

RAIL GRADE CROSSING 1 1 - NOT INVOLVED  
 2 - INVOLVED-ACTIVE CROSSING  
 3 - INVOLVED-PASSIVE CROSSING

**UNIT / NON-MOTORIST DIRECTION**

FROM 2 TO 1

1 - NORTH 5 - NORTHEAST  
 2 - SOUTH 6 - NORTHWEST  
 3 - EAST 7 - SOUTHEAST  
 4 - WEST 8 - SOUTHWEST  
 9 - OTHER / UNKNOWN

UNIT SPEED 75

POSTED SPEED 70

DETECTED SPEED 1 1 - STATED / ESTIMATED SPEED  
 2 - CALCULATED / EOR  
 3 - UNDETERMINED



# MOTORIST / Non-MOTORIST

LOCAL REPORT NUMBER  
2023003

UNIT # 01	NAME: LAST, FIRST, MIDDLE SMITH ALLISON MARIE				DATE OF BIRTH 12/15/1988	AGE 34	GENDER F			
ADDRESS: STREET, CITY, STATE, ZIP 901 SOUTHERLY RD 518 TOWSON MD 21204					CONTACT PHONE - INCLUDE AREA CODE					
INJURIES 5	INJURED TAKEN BY	EMS AGENCY (NAME)	INJURED TAKEN TO: MEDICAL FACILITY (NAME, CITY)	SAFETY EQUIPMENT USED 4	<input type="checkbox"/> DOT-COMPLIANT MC HELMET	SEATING POSITION 1	AIR BAG USAGE 1	EJECTION 1	TRAPPED 1	
OL STATE MD	OPERATOR LICENSE NUMBER S530051585952		OFFENSE CHARGED	LOCAL CODE	OFFENSE DESCRIPTION			CITATION NUMBER		
OL CLASS 3	ENDORSEMENT	RESTRICTION SELECT UP TO 3	DRIVER DISTRACTED BY 1	ALCOHOL / DRUG SUSPECTED <input type="checkbox"/> ALCOHOL <input type="checkbox"/> MARIJUANA <input type="checkbox"/> OTHER DRUG	CONDITION 1	ALCOHOL TEST STATUS TYPE VALUE			DRUG TEST(S) STATUS TYPE RESULT SELECT UP TO 4	

UNIT # 02	NAME: LAST, FIRST, MIDDLE DRAZIL BRANDON ERIK				DATE OF BIRTH 01/08/2002	AGE 20	GENDER M			
ADDRESS: STREET, CITY, STATE, ZIP 9125 CAMBRIDGE DR NORTHFIELD OH 44067					CONTACT PHONE - INCLUDE AREA CODE 216-410-4039					
INJURIES 5	INJURED TAKEN BY	EMS AGENCY (NAME)	INJURED TAKEN TO: MEDICAL FACILITY (NAME, CITY)	SAFETY EQUIPMENT USED 4	<input type="checkbox"/> DOT-COMPLIANT MC HELMET	SEATING POSITION 1	AIR BAG USAGE 1	EJECTION 1	TRAPPED 1	
OL STATE OH	OPERATOR LICENSE NUMBER UV356127		OFFENSE CHARGED	LOCAL CODE	OFFENSE DESCRIPTION			CITATION NUMBER		
OL CLASS 4	ENDORSEMENT	RESTRICTION SELECT UP TO 3	DRIVER DISTRACTED BY 1	ALCOHOL / DRUG SUSPECTED <input type="checkbox"/> ALCOHOL <input type="checkbox"/> MARIJUANA <input type="checkbox"/> OTHER DRUG	CONDITION 1	ALCOHOL TEST STATUS TYPE VALUE			DRUG TEST(S) STATUS TYPE RESULT SELECT UP TO 4	

UNIT #	NAME: LAST, FIRST, MIDDLE				DATE OF BIRTH //	AGE	GENDER			
ADDRESS: STREET, CITY, STATE, ZIP					CONTACT PHONE - INCLUDE AREA CODE					
INJURIES	INJURED TAKEN BY	EMS AGENCY (NAME)	INJURED TAKEN TO: MEDICAL FACILITY (NAME, CITY)	SAFETY EQUIPMENT USED	<input type="checkbox"/> DOT-COMPLIANT MC HELMET	SEATING POSITION	AIR BAG USAGE	EJECTION	TRAPPED	
OL STATE	OPERATOR LICENSE NUMBER		OFFENSE CHARGED	LOCAL CODE	OFFENSE DESCRIPTION			CITATION NUMBER		
OL CLASS	ENDORSEMENT	RESTRICTION SELECT UP TO 3	DRIVER DISTRACTED BY	ALCOHOL / DRUG SUSPECTED <input type="checkbox"/> ALCOHOL <input type="checkbox"/> MARIJUANA <input type="checkbox"/> OTHER DRUG	CONDITION	ALCOHOL TEST STATUS TYPE VALUE			DRUG TEST(S) STATUS TYPE RESULT SELECT UP TO 4	

INJURIES	SEATING POSITION	AIR BAG	OL CLASS	OL RESTRICTION(S)	DRIVER DISTRACTION	TEST STATUS
1-FATAL	1-FRONT - LEFT SIDE (MOTORCYCLE DRIVER)	1-NOT DEPLOYED	1-CLASS A	1-ALCOHOL INTERLOCK DEVICE	1-NOT DISTRACTED	1-NONE GIVEN
2-SUSPECTED SERIOUS INJURY	2-FRONT - MIDDLE	2-DEPLOYED FRONT	2-CLASS B	2-CDL INTRASTATE ONLY	2-MANUALLY OPERATING AN ELECTRONIC COMMUNICATION DEVICE (TEXTING, TYPING, DIALING)	2-TEST REFUSED
3-SUSPECTED MINOR INJURY	3-FRONT - RIGHT SIDE	3-DEPLOYED SIDE	3-CLASS C	3-CORRECTIVE LENSES	3-TALKING ON HANDS-FREE COMMUNICATION DEVICE	3-TEST GIVEN, CONTAMINATED SAMPLE / UNUSABLE
4-POSSIBLE INJURY	4-SECOND - LEFT SIDE (MOTORCYCLE PASSENGER)	4-DEPLOYED BOTH FRONT / SIDE	4-REGULAR CLASS (OHIO = D)	4-FARM WAIVER	4-TALKING ON HAND-HELD COMMUNICATION DEVICE	4-TEST GIVEN, RESULTS KNOWN
5-NO APPARENT INJURY	5-SECOND - MIDDLE	5-NOT APPLICABLE	5-MC MOPED ONLY	5-EXCEPT CLASS A & CLASS B BUS	5-OTHER ACTIVITY WITH AN ELECTRONIC DEVICE	5-TEST GIVEN, RESULTS UNKNOWN
INJURED TAKEN BY	6-SECOND - RIGHT SIDE	9-DEPLOYMENT UNKNOWN	6-NONVALID OL	7-EXCEPT TRACTOR-TRAILER	6-PASSENGER	ALCOHOL TEST TYPE
1-NOT TRANSPORTED / TREATED AT SCENE	7-THIRD - LEFT SIDE (MOTORCYCLE SIDE CAR)	EJECTION	H-HAZMAT	8-INTERMEDIATE LICENSE RESTRICTIONS	7-OTHER DISTRACTION INSIDE THE VEHICLE	1-NONE
2-EMS	8-THIRD - MIDDLE	1-NOT EJECTED	M-MOTORCYCLE	9-LEARNER'S PERMIT RESTRICTIONS	8-OTHER DISTRACTION OUTSIDE THE VEHICLE	2-BLOOD
3-POLICE	9-THIRD - RIGHT SIDE	2-PARTIALLY EJECTED	P-PASSENGER	10-LIMITED TO DAYLIGHT ONLY	9-OTHER / UNKNOWN	3-URINE
9-OTHER / UNKNOWN	10-SLEEPER SECTION OF TRUCK CAB	3-TOTALLY EJECTED	N-TANKER	11-LIMITED TO EMPLOYMENT	CONDITION	4-BREATH
SAFETY EQUIPMENT	11-PASSENGER IN OTHER ENCLOSED CARGO AREA (NON-TRAILING UNIT, BUS, PICK-UP WITH CAP)	4-NOT APPLICABLE	Q-MOTOR SCOOTER	12-LIMITED - OTHER	1-APPARENTLY NORMAL	5-OTHER
1-NONE USED	12-PASSENGER IN UNENCLOSED CARGO AREA	TRAPPED	R-THREE-WHEEL MOTORCYCLE	13-MECHANICAL DEVICES (SPECIAL BRAKES, HAND CONTROLS, OR OTHER ADAPTIVE DEVICES)	2-PHYSICAL IMPAIRMENT	DRUG TEST TYPE
2-SHOULDER BELT ONLY USED	13-TRAILING UNIT	1-NOT TRAPPED	S-SCHOOL BUS	14-MILITARY VEHICLES ONLY	3-EMOTIONAL (E.G., DEPRESSED, ANGRY, DISTURBED)	1-NONE
3-LAP BELT ONLY USED	14-RIDING ON VEHICLE EXTERIOR (NON-TRAILING UNIT)	2-EXTRICATED BY MECHANICAL MEANS	T-DOUBLE & TRIPLE TRAILERS	15-MOTOR VEHICLES WITHOUT AIR BRAKES	4-ILLNESS	2-BLOOD
4-SHOULDER & LAP BELT USED	15-NON-MOTORIST	3-FREED BY NON-MECHANICAL MEANS	X-TANKER / HAZMAT	16-OUTSIDE MIRROR	5-FELL ASLEEP, FAINTED, FATIGUED, ETC.	3-URINE
5-CHILD RESTRAINT SYSTEM - FORWARD FACING	99-OTHER / UNKNOWN			17-PROSTHETIC AID	6-UNDER THE INFLUENCE OF MEDICATIONS / DRUGS / ALCOHOL	4-OTHER
6-CHILD RESTRAINT SYSTEM - REAR FACING				18-OTHER	9-OTHER / UNKNOWN	DRUG TEST RESULT(S)
7-BOOSTER SEAT						1-AMPHETAMINES
8-HELMET USED						2-BARBITURATES
9-PROTECTIVE PADS USED (ELBOW, KNEES, ETC.)						3-BENZODIAZEPINES
10-REFLECTIVE CLOTHING						4-CANNABINOIDS
11-LIGHTING - PEDESTRIAN / BICYCLE ONLY						5-COCAINE
99-OTHER / UNKNOWN						6-OPiates / OPIOIDS
						7-OTHER
						8-NEGATIVE RESULTS