

TRAFFIC CRASH REPORT

*DENOTES MANDATORY FIELD FOR SUPPLEMENT REPORT

LOCAL REPORT NUMBER*

2023054

PHOTOS TAKEN
 SECONDARY CRASH
 OH-2
 OH-1P
 OTHER
 PRIVATE PROPERTY

LOCAL INFORMATION CLEVELAND MASSILLION
 REPORTING AGENCY NAME* RICHFIELD POLICE
 NCIC* 07726

HIT/SKIP
 1 - SOLVED
 2 - UNSOLVED
 NUMBER OF UNITS 01
 UNIT IN ERROR
 98 - ANIMAL
 99 - UNKNOWN

COUNTY* 77 LOCALITY* 3
 1 - CITY
 2 - VILLAGE
 3 - TOWNSHIP
 LOCATION: CITY, VILLAGE, TOWNSHIP* RICHFIELD

CRASH DATE / TIME* 05/06/2023 00:37
 CRASH SEVERITY
 1 - FATAL
 2 - SERIOUS INJURY SUSPECTED
 3 - MINOR INJURY SUSPECTED
 4 - INJURY POSSIBLE
 5 - PROPERTY DAMAGE ONLY

ROUTE TYPE ROUTE NUMBER PREFIX N - NORTH
 S - SOUTH
 E - EAST
 W - WEST
 LOCATION ROAD NAME N CLEVELAND MASSILLION
 ROAD TYPE RD

LATITUDE DECIMAL DEGREES 41.194896

ROUTE TYPE ROUTE NUMBER PREFIX N - NORTH
 S - SOUTH
 E - EAST
 W - WEST
 REFERENCE ROAD NAME (ROAD, MILEPOST, HOUSE #) AEGEAN
 ROAD TYPE DR

LONGITUDE DECIMAL DEGREES 81.636161

REFERENCE POINT
 1 - INTERSECTION
 2 - MILE POST
 3 - HOUSE #
 DIRECTION FROM REFERENCE N
 N - NORTH
 S - SOUTH
 E - EAST
 W - WEST
 ROUTE TYPE
 IR - INTERSTATE ROUTE (TP)
 US - FEDERAL US ROUTE
 SR - STATE ROUTE
 CR - NUMBERED COUNTY ROUTE
 TR - NUMBERED TOWNSHIP ROUTE
 ROAD TYPE
 AL - ALLEY
 AV - AVENUE
 BL - BOULEVARD
 CR - CIRCLE
 CT - COURT
 DR - DRIVE
 HE - HEIGHTS
 HW - HIGHWAY
 LA - LANE
 MP - MILEPOST
 OV - OVAL
 PK - PARKWAY
 PI - PIKE
 PL - PLACE
 RD - ROAD
 SQ - SQUARE
 ST - STREET
 TE - TERRACE
 TL - TRAIL
 WA - WAY

INTERSECTION RELATED
 WITHIN INTERSECTION OR ON APPROACH
 WITHIN INTERCHANGE AREA
 NUMBER OF APPROACHES 3
 ROADWAY
 ROADWAY DIVIDED

LOCATION OF FIRST HARMFUL EVENT
 1 - ON ROADWAY
 2 - ON SHOULDER
 3 - IN MEDIAN
 4 - ON ROADSIDE
 5 - ON GORE
 6 - OUTSIDE TRAFFIC WAY
 7 - ON RAMP
 8 - OFF RAMP
 9 - CROSSOVER
 10 - DRIVEWAY/ALLEY ACCESS
 11 - RAILWAY GRADE CROSSING
 12 - SHARED USE PATHS OR TRAILS
 13 - BIKE LANE
 14 - TOLL BOOTH
 99 - OTHER / UNKNOWN

MANNER OF CRASH COLLISION/IMPACT
 1 - NOT COLLISION BETWEEN TWO MOTOR VEHICLES IN TRANSPORT
 2 - REAR-END
 3 - HEAD-ON
 4 - REAR-TO-REAR
 5 - BACKING
 6 - ANGLE
 7 - SIDESWIPE, SAME DIRECTION
 8 - SIDESWIPE, OPPOSITE DIRECTION
 9 - OTHER / UNKNOWN

DIRECTION OF TRAVEL
 N - NORTH
 S - SOUTH
 E - EAST
 W - WEST
 MEDIAN TYPE
 1 - DIVIDED FLUSH MEDIAN (<4 FEET)
 2 - DIVIDED FLUSH MEDIAN (>4 FEET)
 3 - DIVIDED, DEPRESSED MEDIAN
 4 - DIVIDED, RAISED MEDIAN (ANY TYPE)
 9 - OTHER/UNKNOWN

WORK ZONE RELATED
 WORKERS PRESENT
 LAW ENFORCEMENT PRESENT
 ACTIVE SCHOOL ZONE

WORK ZONE TYPE
 1 - LANE CLOSURE
 2 - LANE SHIFT/CROSSOVER
 3 - WORK ON SHOULDER OR MEDIAN
 4 - INTERMITTENT OR MOVING WORK
 5 - OTHER

LOCATION OF CRASH IN WORK ZONE
 1 - BEFORE THE 1ST WORK ZONE WARNING SIGN
 2 - ADVANCE WARNING AREA
 3 - TRANSITION AREA
 4 - ACTIVITY AREA
 5 - TERMINATION AREA

CONTOUR
 1 - STRAIGHT LEVEL
 2 - STRAIGHT GRADE
 3 - CURVE LEVEL
 4 - CURVE GRADE
 9 - OTHER/UNKNOWN

CONDITIONS
 1 - DRY
 2 - WET
 3 - SNOW
 4 - ICE
 5 - SAND, MUD, DIRT, OIL, GRAVEL
 6 - WATER (STANDING, MOVING)
 7 - SLUSH
 9 - OTHER/UNKNOWN

SURFACE
 1 - CONCRETE
 2 - BLACKTOP, BITUMINOUS, ASPHALT
 3 - BRICK/BLOCK
 4 - SLAG, GRAVEL, STONE
 5 - DIRT
 9 - OTHER/UNKNOWN

LIGHT CONDITION
 1 - DAYLIGHT
 2 - DAWN/DUSK
 3 - DARK - LIGHTED ROADWAY
 4 - DARK - ROADWAY NOT LIGHTED
 5 - DARK - UNKNOWN ROADWAY LIGHTING
 9 - OTHER / UNKNOWN

WEATHER
 1 - CLEAR
 2 - CLOUDY
 3 - FOG, SMOG, SMOKE
 4 - RAIN
 5 - SLEET, HAIL
 6 - SNOW
 7 - SEVERE CROSSWINDS
 8 - BLOWING SAND, SOIL, DIRT, SNOW
 9 - FREEZING RAIN OR FREEZING DRIZZLE
 99 - OTHER / UNKNOWN

Unit #1 was fleeing south on Cleveland Massillon Road and traveled left of center, crossing the center line at the intersection of Aegean Road. Unit #1 and traveled off the left side of the roadway. The rider of unit #1 was tossed free of the vehicle. Unit#1 continued south coming to rest on the shoulder.

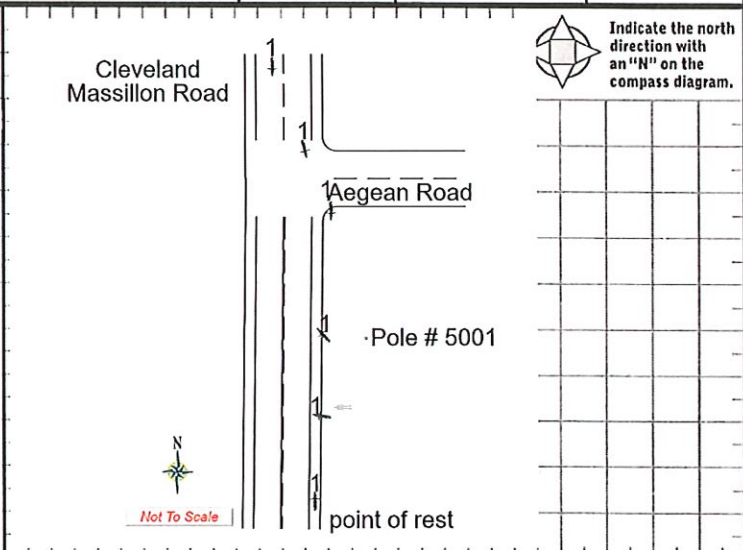

CRASH REPORTED DATE / TIME 05/06/2023 00:37		DISPATCH DATE / TIME 05/06/2023 00:37		ARRIVAL DATE / TIME 05/06/2023 00:37		SCENE CLEARED DATE / TIME 05/06/2023 01:33		REPORT TAKEN BY <input checked="" type="checkbox"/> POLICE AGENCY <input type="checkbox"/> MOTORIST
TOTAL TIME ROADWAY CLOSED 0	OTHER INVESTIGATION TIME 60	TOTAL MINUTES 116	OFFICER'S NAME* RUDOLPH PRHNE	CHECKED BY OFFICER'S NAME* MICHAEL TESTA	OFFICER'S BADGE NUMBER* 713	CHECKED BY OFFICER'S BADGE NUMBER* 717	SUPPLEMENT (CORRECTION OR ADDITION TO AN EXISTING REPORT SENT TO DSP)	

OWNER

UNIT # **01** OWNER NAME: LAST, FIRST, MIDDLE (SAME AS DRIVER) **PELTIER COREY NICHOLAS** OWNER PHONE: INCLUDE AREA CODE (SAME AS DRIVER) **678-938-0875**

OWNER ADDRESS: STREET, CITY, STATE, ZIP (SAME AS DRIVER) **1416 CASTLEWOOD AVE SW NORTH CANTON OH 44720**

COMMERCIAL CARRIER: NAME, ADDRESS, CITY, STATE, ZIP _____ COMMERCIAL CARRIER PHONE: INCLUDE AREA CODE _____

VEHICLE

LP STATE **OH** LICENSE PLATE # **JCK20** VEHICLE IDENTIFICATION # **JYARN33E7GA009392** VEHICLE YEAR **2016** VEHICLE MAKE **YAMAHA**

INSURANCE VERIFIED _____ INSURANCE COMPANY _____ INSURANCE POLICY # _____ COLOR **BLU /** VEHICLE MODEL **RT**

COMMERCIAL GOVERNMENT IN EMERGENCY RESPONSE

INTERLOCK DEVICE EQUIPPED HIT/SKIP UNIT #OCCUPANTS **01** VEHICLE WEIGHT GVWR/GCWR **1**

US DOT # _____ TOWED BY: COMPANY NAME **WORLD** HAZARDOUS MATERIAL CLASS # _____ PLACARD ID # _____

UNIT TYPE **7**

1 - PASSENGER CAR 7 - MOTORCYCLE 2-WHEELED 12 - GOLF CART 18 - LIMO (LIVERY VEHICLE) 23 - PEDESTRIAN / SKATER
 2 - PASSENGER VAN (MINIVAN) 8 - MOTORCYCLE 3-WHEELED 13 - SNOWMOBILE 19 - BUS (16+ PASSENGERS) 24 - WHEELCHAIR (ANY TYPE)
 3 - SPORT UTILITY VEHICLE 9 - AUTOCYCLE 14 - SINGLE UNIT TRUCK 20 - OTHER VEHICLE 25 - OTHER NON-MOTORIST
 4 - PICK UP 10 - MOPED OR MOTORIZED BICYCLE 15 - SEMI-TRACTOR 21 - HEAVY EQUIPMENT 26 - BICYCLE
 5 - CARGOVAN 6 - VAN (9-15 SEATS) 11 - ALL TERRAIN VEHICLE (ATV / UTV) 16 - FARM EQUIPMENT 22 - ANIMAL WITH RIDER OR ANIMAL-DRAWN VEHICLE 99 - UNKNOWN OR HIT/SKIP

of TRAILING UNITS _____

WAS VEHICLE OPERATING IN AUTONOMOUS MODE WHEN CRASH OCCURRED? **2**

1 - YES 2 - NO 9 - OTHER / UNKNOWN

AUTONOMOUS MODE LEVEL **0**

0 - NO AUTOMATION 1 - DRIVER ASSISTANCE 2 - PARTIAL AUTOMATION 3 - CONDITIONAL AUTOMATION 4 - HIGH AUTOMATION 5 - FULL AUTOMATION 9 - UNKNOWN

SPECIAL FUNCTION **1**

1 - NONE 2 - TAXI 3 - ELECTRONIC RIDE SHARING 4 - SCHOOL TRANSPORT 5 - BUS - TRANSIT/COMMUTER

6 - BUS - CHARTER/TOUR 7 - BUS - INTERCITY 8 - BUS - SHUTTLE 9 - BUS - OTHER 10 - AMBULANCE

11 - FIRE 12 - MILITARY 13 - POLICE 14 - PUBLIC UTILITY 15 - CONSTRUCTION EQUIPMENT

16 - FARM 17 - MOWING 18 - SNOW REMOVAL 19 - TOWING 20 - SAFETY SERVICE PATROL

21 - MAIL CARRIER 99 - OTHER / UNKNOWN

CARGO BODY TYPE **1**

1 - NO CARGO BODY TYPE / NOT APPLICABLE 2 - BUS

3 - VEHICLE TOWING ANOTHER MOTORVEHICLE 4 - LOGGING

5 - INTERMODAL CONTAINER CHASSIS 6 - CARGOVAN/ENCLOSED BIX 7 - GRAIN/CHIPS/GRAVEL

8 - POLE 9 - CARGO TANK 10 - FLAT BED 11 - DUMP

12 - CONCRETE MIXER 13 - AUTO TRANSPORTER 14 - GARBAGE/REFUSE 99 - OTHER / UNKNOWN

VEHICLE DEFECTS **1**

1 - TURN SIGNALS 2 - HEAD LAMPS 3 - TAIL LAMPS

4 - BRAKES 5 - STEERING 6 - TIRE BLOWOUT

7 - WORN OR SLICK TIRES 8 - TRAILER EQUIPMENT DEFECTIVE

9 - MOTOR TROUBLE 10 - DISABLED FROM PRIOR ACCIDENT 99 - OTHER / UNKNOWN

NON-MOTORIST LOCATION AT IMPACT _____

1 - INTERSECTION - MARKED CROSSWALK 2 - INTERSECTION - UNMARKED CROSSWALK 3 - INTERSECTION - OTHER 4 - MIDBLOCK - MARKED CROSSWALK 5 - TRAVEL LANE - OTHER LOCATION

6 - BICYCLE LANE 7 - SHOULDER / ROADSIDE 8 - SIDEWALK

9 - MEDIUM CROSSING ISLAND 10 - DRIVEWAY ACCESS 11 - SHARED USE PATHS OR TRAILS

12 - FIRST RESPONDER AT INCIDENT SCENE 99 - OTHER / UNKNOWN

ACTION **1**

1 - NON-CONTACT 2 - NON-COLLISION 3 - STRIKING 4 - STRUCK 5 - BOTH STRIKING & STRUCK 9 - OTHER / UNKNOWN

1 - STRAIGHT AHEAD 2 - BACKING 3 - CHANGING LANES 4 - OVERTAKING/PASSING 5 - MAKING RIGHT TURN 6 - MAKING LEFT TURN

7 - MAKING U-TURN 8 - ENTERING TRAFFIC LANE 9 - LEAVING TRAFFIC LANE 10 - PARKED 11 - SLOWING OR STOPPED IN TRAFFIC 12 - DRIVERLESS

13 - NEGOTIATING A CURVE 14 - ENTERING OR CROSSING SPECIFIED LOCATION 15 - WALKING, RUNNING, JOGGING, PLAYING 16 - WORKING 17 - PUSHING VEHICLE

18 - APPROACHING OR LEAVING VEHICLE 19 - STANDING 20 - OTHER NON-MOTORIST 21 - STANDING OUTSIDE DISABLED VEHICLE 99 - OTHER / UNKNOWN

CONTRIBUTING CIRCUMSTANCES **5**

1 - NONE 2 - FAILURE TO YIELD 3 - RAN RED LIGHT 4 - RAN STOP SIGN 5 - UNSAFE SPEED 6 - IMPROPER TURN

7 - LEFT OF CENTER 8 - FOLLOWING TOO CLOSE / ACD/A 9 - IMPROPER LANE CHANGE 10 - IMPROPER PASSING 11 - DROVE OFF ROAD 12 - IMPROPER BACKING

13 - IMPROPER START FROM A PARKED POSITION 14 - STOPPED OR PARKED ILLEGALLY 15 - SWERVING TO AVOID 16 - WRONG WAY

17 - VISION OBSTRUCTION 18 - OPERATING DEFECTIVE EQUIPMENT 19 - LOAD SHIFTING/FALLING/ SPILLING 20 - IMPROPER CROSSING

21 - LYING IN ROADWAY 22 - NOT DISCERNIBLE 23 - OPENING DOOR INTO ROADWAY 99 - OTHER IMPROPER ACTION

SEQUENCE OF EVENTS

1 **11** 1 - OVERTURN/ROLLOVER 2 - FIRE/EXPLOSION 3 - IMMERSION 4 - JACKKNIFE 5 - CARGO/EQUIPMENT LOSS OR SHIFT

2 **9** 6 - EQUIPMENT FAILURE 7 - SEPARATION OF UNITS 8 - RAN OFF ROAD RIGHT 9 - RAN OFF ROAD LEFT 10 - CROSS MEDIUM

3 _____

4 _____

5 _____

6 _____

COLLISION WITH FIXED OBJECT - STRUCK

31 - GUARDRAIL END 32 - PORTABLE BARRIER 33 - MEDIUM CABLE BARRIER 34 - MEDIUM GUARDRAIL BARRIER 35 - MEDIUM CONCRETE BARRIER 36 - MEDIUM OTHER BARRIER

37 - TRAFFIC SIGN POST 38 - OVERHEAD SIGN POST 39 - LIGHT / LUMINARIES SUPPORT 40 - UTILITY POLE 41 - OTHER POST, POLE OR SUPPORT 42 - CULVERT

43 - CURB 44 - DITCH 45 - EMBANKMENT 46 - FENCE 47 - MAILBOX 48 - TREE 49 - FIRE HYDRANT

50 - WORK ZONE MAINTENANCE EQUIPMENT 51 - WALL 52 - BUILDING 53 - TUNNEL 54 - OTHER FIXED OBJECT 99 - OTHER / UNKNOWN

FIRST HARMFUL EVENT **2** MOST HARMFUL EVENT **2**

DAMAGE

DAMAGE SCALE **3**

1 - NONE 2 - MINOR DAMAGE 3 - FUNCTIONAL DAMAGE 4 - DISABLING DAMAGE 9 - UNKNOWN

DAMAGED AREA(S) INDICATE ALL THAT APPLY

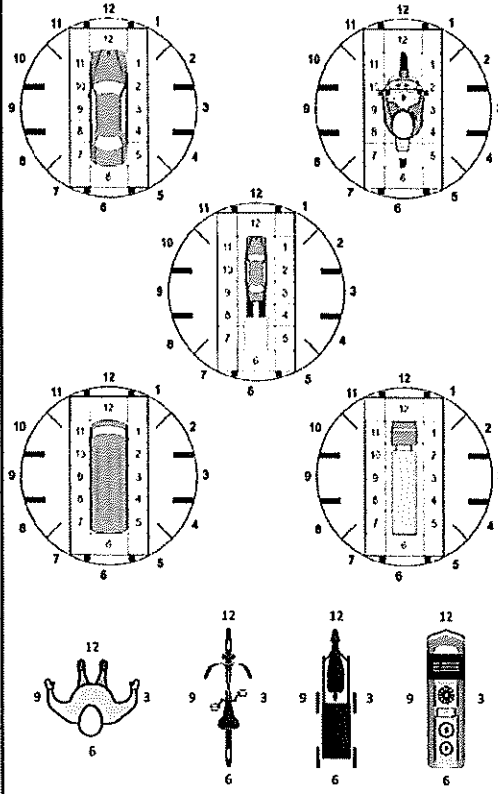

NO DAMAGE [0] UNDERCARRIAGE [14]

TOP [13] ALL AREAS [15]

UNIT NOT AT SCENE [16]

INITIAL POINT OF CONTACT **99**

0 - NO DAMAGE 14 - UNDERCARRIAGE 15 - VEHICLE NOT AT SCENE 99 - UNKNOWN

1-12 - REFER TO UNIT DIAGRAM 13 - TOP

TRAFFIC

TRAFFICWAY FLOW **2**

1 - ONE-WAY 2 - TWO-WAY

TRAFFIC CONTROL **6**

1 - ROUNDABOUT 2 - SIGNAL 3 - FLASHER 4 - STOP SIGN 5 - YIELD SIGN 6 - NO CONTROL

of THROUGH LANES ON ROAD **2**

RAIL GRADE CROSSING **1**

1 - NOT INVOLVED 2 - INVOLVED-ACTIVE CROSSING 3 - INVOLVED-PASSIVE CROSSING

UNIT / NON-MOTORIST DIRECTION

FROM **1** TO **2**

1 - NORTH 2 - SOUTH 3 - EAST 4 - WEST 5 - NORTHEAST 6 - NORTHWEST 7 - SOUTHWEST 9 - OTHER / UNKNOWN

UNIT SPEED **90**

POSTED SPEED **40**

DETECTED SPEED **1**

1 - STATED / ESTIMATED SPEED 2 - CALCULATED / EDR 3 - UNDETERMINED



MOTORIST / Non-MOTORIST

LOCAL REPORT NUMBER
2023054

UNIT # 01	NAME: LAST, FIRST, MIDDLE PELTIER COREY NICHOLAS				DATE OF BIRTH 06/09/1988	AGE 34	GENDER M						
ADDRESS: STREET, CITY, STATE, ZIP 1416 CASTLEWOOD AVE SW NORTH CANTON OH 44720					CONTACT PHONE - INCLUDE AREA CODE 678-938-0875								
INJURIES 3	INJURED TAKEN BY 2	EMS AGENCY (NAME) BATH FIRE DEPT.	INJURED TAKEN TO: MEDICAL FACILITY (NAME, CITY) AGMC MAIN	SAFETY EQUIPMENT USED 8	<input checked="" type="checkbox"/> DOT-COMPLIANT MC HELMET	SEATING POSITION 1	AIR BAG USAGE 1	EJECTION 3	TRAPPED 1				
OL STATE OH	OPERATOR LICENSE NUMBER		OFFENSE CHARGED 4511.21	LOCAL CODE <input type="checkbox"/>	OFFENSE DESCRIPTION SPEED (ASSURED CLEAR)			CITATION NUMBER RV59649					
OL CLASS 4	ENDORSEMENT M	RESTRICTION SELECT UP TO 3	DRIVER DISTRACTED BY 1	ALCOHOL / DRUG SUSPECTED <input checked="" type="checkbox"/> ALCOHOL <input type="checkbox"/> MARIJUANA <input type="checkbox"/> OTHER DRUG	CONDITION 6	ALCOHOL TEST STATUS 5	ALCOHOL TEST TYPE 2	ALCOHOL TEST VALUE	ALCOHOL TEST STATUS 5	ALCOHOL TEST TYPE 2	ALCOHOL TEST RESULT SELECT UP TO 4	DRUG TEST(S) TYPE 2	DRUG TEST(S) RESULT SELECT UP TO 4

UNIT #	NAME: LAST, FIRST, MIDDLE				DATE OF BIRTH //	AGE	GENDER						
ADDRESS: STREET, CITY, STATE, ZIP					CONTACT PHONE - INCLUDE AREA CODE								
INJURIES	INJURED TAKEN BY	EMS AGENCY (NAME)	INJURED TAKEN TO: MEDICAL FACILITY (NAME, CITY)	SAFETY EQUIPMENT USED	<input type="checkbox"/> DOT-COMPLIANT MC HELMET	SEATING POSITION	AIR BAG USAGE	EJECTION	TRAPPED				
OL STATE	OPERATOR LICENSE NUMBER		OFFENSE CHARGED	LOCAL CODE <input type="checkbox"/>	OFFENSE DESCRIPTION			CITATION NUMBER					
OL CLASS	ENDORSEMENT	RESTRICTION SELECT UP TO 3	DRIVER DISTRACTED BY	ALCOHOL / DRUG SUSPECTED <input type="checkbox"/> ALCOHOL <input type="checkbox"/> MARIJUANA <input type="checkbox"/> OTHER DRUG	CONDITION	ALCOHOL TEST STATUS	ALCOHOL TEST TYPE	ALCOHOL TEST VALUE	ALCOHOL TEST STATUS	ALCOHOL TEST TYPE	ALCOHOL TEST RESULT SELECT UP TO 4	DRUG TEST(S) TYPE	DRUG TEST(S) RESULT SELECT UP TO 4

UNIT #	NAME: LAST, FIRST, MIDDLE				DATE OF BIRTH //	AGE	GENDER						
ADDRESS: STREET, CITY, STATE, ZIP					CONTACT PHONE - INCLUDE AREA CODE								
INJURIES	INJURED TAKEN BY	EMS AGENCY (NAME)	INJURED TAKEN TO: MEDICAL FACILITY (NAME, CITY)	SAFETY EQUIPMENT USED	<input type="checkbox"/> DOT-COMPLIANT MC HELMET	SEATING POSITION	AIR BAG USAGE	EJECTION	TRAPPED				
OL STATE	OPERATOR LICENSE NUMBER		OFFENSE CHARGED	LOCAL CODE <input type="checkbox"/>	OFFENSE DESCRIPTION			CITATION NUMBER					
OL CLASS	ENDORSEMENT	RESTRICTION SELECT UP TO 3	DRIVER DISTRACTED BY	ALCOHOL / DRUG SUSPECTED <input type="checkbox"/> ALCOHOL <input type="checkbox"/> MARIJUANA <input type="checkbox"/> OTHER DRUG	CONDITION	ALCOHOL TEST STATUS	ALCOHOL TEST TYPE	ALCOHOL TEST VALUE	ALCOHOL TEST STATUS	ALCOHOL TEST TYPE	ALCOHOL TEST RESULT SELECT UP TO 4	DRUG TEST(S) TYPE	DRUG TEST(S) RESULT SELECT UP TO 4

INJURIES	SEATING POSITION	AIR BAG	OL CLASS	OL RESTRICTION(S)	DRIVER DISTRACTION	TEST STATUS
1 - FATAL	1 - FRONT - LEFT SIDE (MOTORCYCLE DRIVER)	1 - NOT DEPLOYED	1 - CLASS A	1 - ALCOHOL INTERLOCK DEVICE	1 - NOT DISTRACTED	1 - NONE GIVEN
2 - SUSPECTED SERIOUS INJURY	2 - FRONT - MIDDLE	2 - DEPLOYED FRONT	2 - CLASS B	2 - CDL INTRASTATE ONLY	2 - MANUALLY OPERATING AN ELECTRONIC COMMUNICATION DEVICE (TEXTING, TYPING, DIALING)	2 - TEST REFUSED
3 - SUSPECTED MINOR INJURY	3 - FRONT - RIGHT SIDE	3 - DEPLOYED SIDE	3 - CLASS C	3 - CORRECTIVE LENSES	3 - TALKING ON HANDS-FREE COMMUNICATION DEVICE	3 - TEST GIVEN, CONTAMINATED SAMPLE / UNUSABLE
4 - POSSIBLE INJURY	4 - SECOND - LEFT SIDE (MOTORCYCLE PASSENGER)	4 - DEPLOYED BOTH FRONT / SIDE	4 - REGULAR CLASS (OHIO - D)	4 - FARM WAIVER	4 - TALKING ON HAND-HELD COMMUNICATION DEVICE	4 - TEST GIVEN, RESULTS KNOWN
5 - NO APPARENT INJURY	5 - SECOND - MIDDLE	5 - NOT APPLICABLE	5 - M/C MOPED ONLY	5 - EXCEPT CLASS A BUS & CLASS B BUS	5 - OTHER ACTIVITY WITH AN ELECTRONIC DEVICE	5 - TEST GIVEN, RESULTS UNKNOWN
6 - SECOND - RIGHT SIDE	6 - SECOND - RIGHT SIDE	9 - DEPLOYMENT UNKNOWN	6 - NO VALID OL	6 - EXCEPT CLASS A & CLASS B BUS	6 - PASSENGER	6 - BLOOD
7 - THIRD - LEFT SIDE (MOTORCYCLE SIDE CAR)	7 - THIRD - LEFT SIDE			7 - EXCEPT TRACTOR-TRAILER	7 - OTHER DISTRACTION INSIDE THE VEHICLE	7 - URINE
8 - THIRD - MIDDLE	8 - THIRD - MIDDLE	EJECTION		8 - INTERMEDIATE LICENSE RESTRICTIONS	8 - OTHER DISTRACTION OUTSIDE THE VEHICLE	8 - OTHER
9 - THIRD - RIGHT SIDE	9 - THIRD - RIGHT SIDE	1 - NOT EJECTED		9 - LEARNER'S PERMIT RESTRICTIONS	9 - OTHER / UNKNOWN	9 - OTHER
10 - SLEEPER SECTION OF TRUCK CAB	10 - SLEEPER SECTION OF TRUCK CAB	2 - PARTIALLY EJECTED		10 - LIMITED TO DAYLIGHT ONLY		
11 - PASSENGER IN OTHER ENCLOSED CARGO AREA (NON-TRAILING UNIT, BUS, PICK-UP WITH CAP)	11 - PASSENGER IN OTHER ENCLOSED CARGO AREA (NON-TRAILING UNIT, BUS, PICK-UP WITH CAP)	3 - TOTALLY EJECTED		11 - LIMITED TO EMPLOYMENT		
12 - PASSENGER IN UNENCLOSED CARGO AREA	12 - PASSENGER IN UNENCLOSED CARGO AREA	4 - NOT APPLICABLE		12 - LIMITED - OTHER		
13 - TRAILING UNIT	13 - TRAILING UNIT			13 - MECHANICAL DEVICES (SPECIAL BRAKES, HAND CONTROLS, OR OTHER ADAPTIVE DEVICES)		
14 - RIDING ON VEHICLE EXTERIOR (NON-TRAILING UNIT)	14 - RIDING ON VEHICLE EXTERIOR (NON-TRAILING UNIT)	TRAPPED		14 - MILITARY VEHICLES ONLY		
15 - NON-MOTORIST	15 - NON-MOTORIST	1 - NOT TRAPPED		15 - MOTOR VEHICLES WITHOUT AIR BRAKES		
99 - OTHER / UNKNOWN	99 - OTHER / UNKNOWN	2 - EXTRICATED BY MECHANICAL MEANS		16 - OUTSIDE MIRROR		
		3 - FREED BY NON-MECHANICAL MEANS		17 - PROSTHETIC AID		
				18 - OTHER		
					CONDITION	
					1 - APPARENTLY NORMAL	
					2 - PHYSICAL IMPAIRMENT	
					3 - EMOTIONAL (E.G. DEPRESSED, ANGRY, DISTURBED)	
					4 - ILLNESS	
					5 - FELL ASLEEP, FAINTED, FATIGUED, ETC.	
					6 - UNDER THE INFLUENCE OF MEDICATIONS / DRUGS / ALCOHOL	
					9 - OTHER / UNKNOWN	
						DRUG TEST TYPE
						1 - NONE
						2 - BLOOD
						3 - URINE
						4 - OTHER
						DRUG TEST RESULT(S)
						1 - AMPHETAMINES
						2 - BARBITURATES
						3 - BENZODIAZEPINES
						4 - CANNABINOIDS
						5 - COCAINE
						6 - OPIATES / OPIOIDS
						7 - OTHER
						8 - NEGATIVE RESULTS